

# Oceanz

BY **DANUBE**

## Floor Plans



An aerial photograph of a modern skyscraper with a distinctive stepped-top design, illuminated with blue lights. The building is situated on a waterfront promenade. In the foreground, a large swimming pool with a blue cover is visible, with the word 'DANLIFE' printed on its side. Several boats are docked at a pier in the water. The background shows a city skyline across a body of water under a sunset sky.

*Pause & unwind with*  
SUBLIME SUNSETS

1. All Information, materials, plans and amenities are approximate and provided for illustrative purposes only. The developer reserves the right to make revisions to the floor plans and any features, materials, dimensions, drawings, and amenities of the project without notice.
2. Units areas, actual dimensions, layout, location, specifications of balcony, door, wardrobe or other fixtures may vary floor to floor and between units and are subject to revision by the developer.
3. Furniture and electric devices will not be provided by the developer, unless specified otherwise in the Unit Sale Purchase Agreement.



# 40+ Amenities



Infinity Pool



Doctor on Call



Aquatic Gym



Daycare Center



BBQ Area



Sunset Deck



Sky Jacuzzi



Kids Play Area



GYM



Floating Cinema



Cricket Pitch



Jogging Track



Paddle Tennis



Basketball Court



SPA & Therapy



Relaxation Zone

# STUDIO

TYPE - A

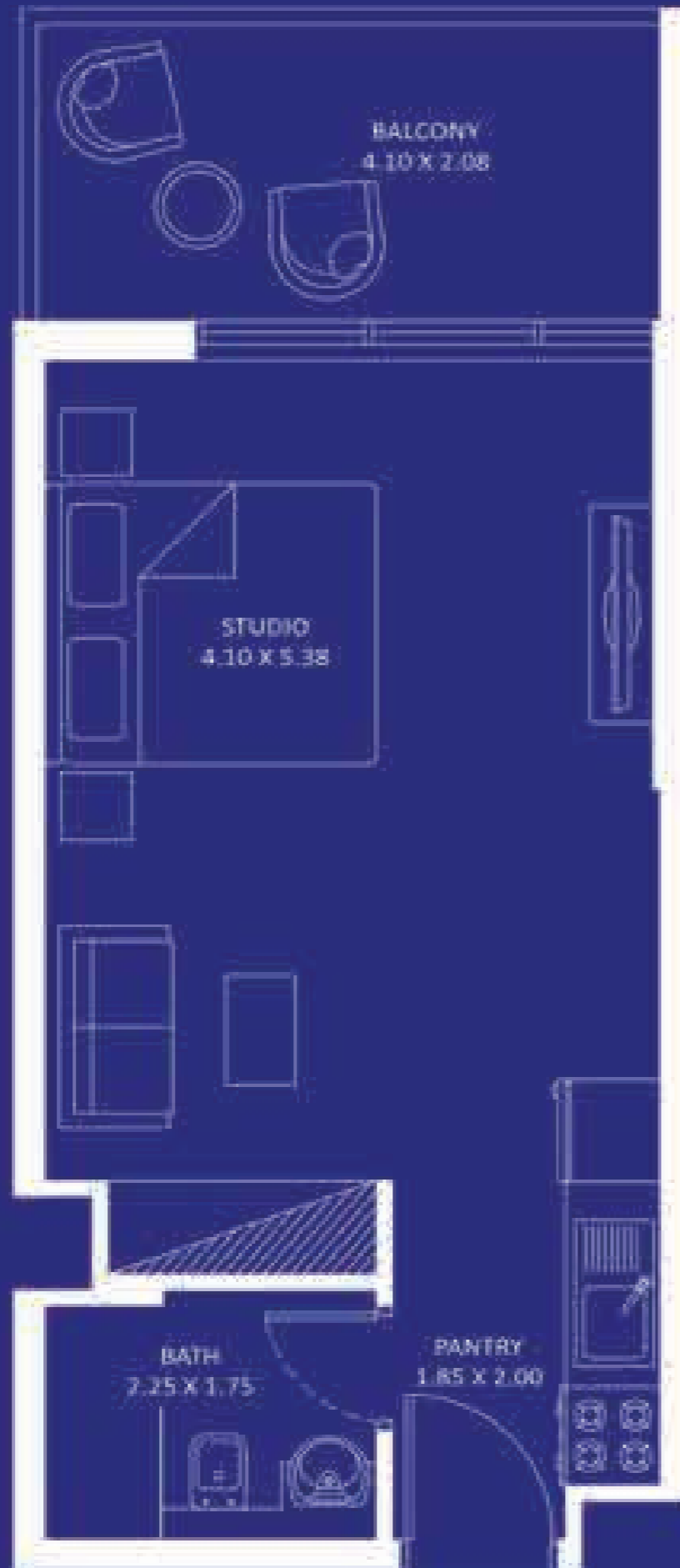

## AREA (Sq.Ft)

Apartment  
335 to 338

Balcony  
76 to 95

Total  
412 to 431

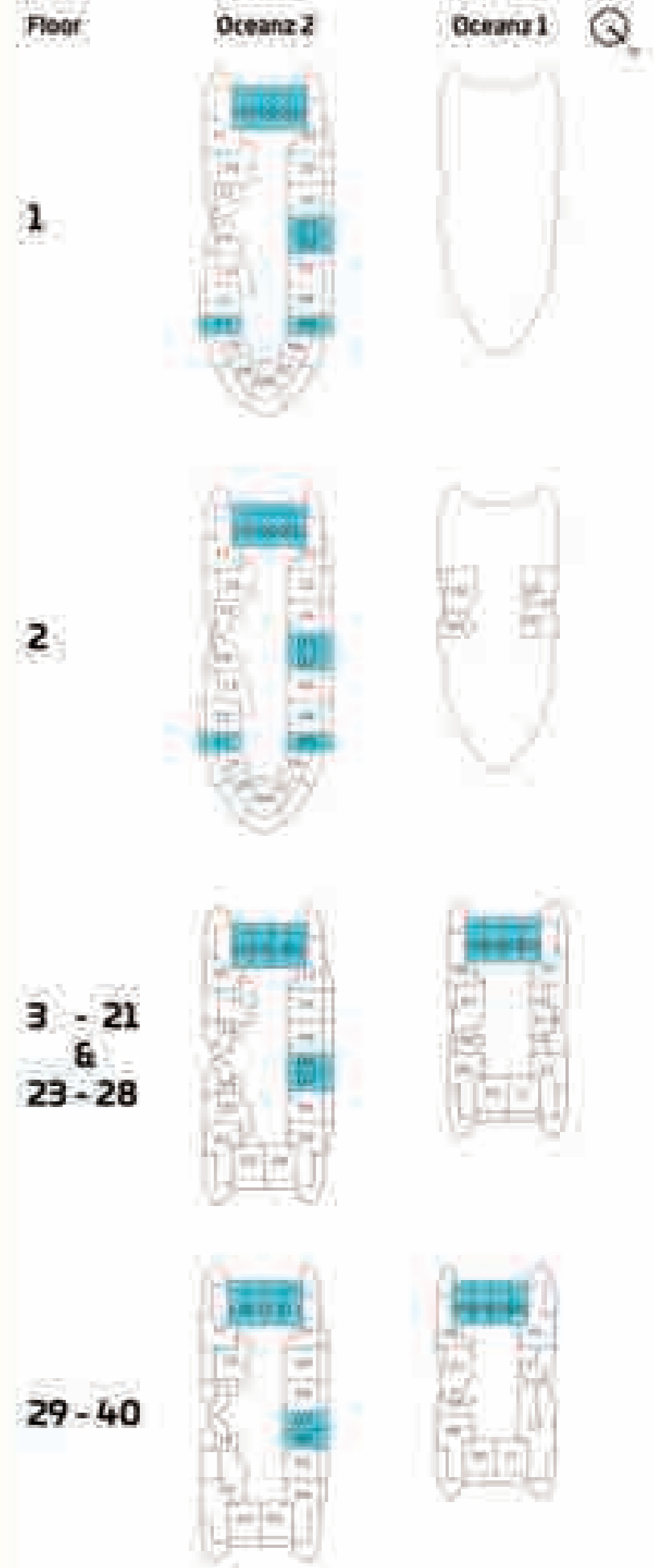

# STUDIO

TYPE - B

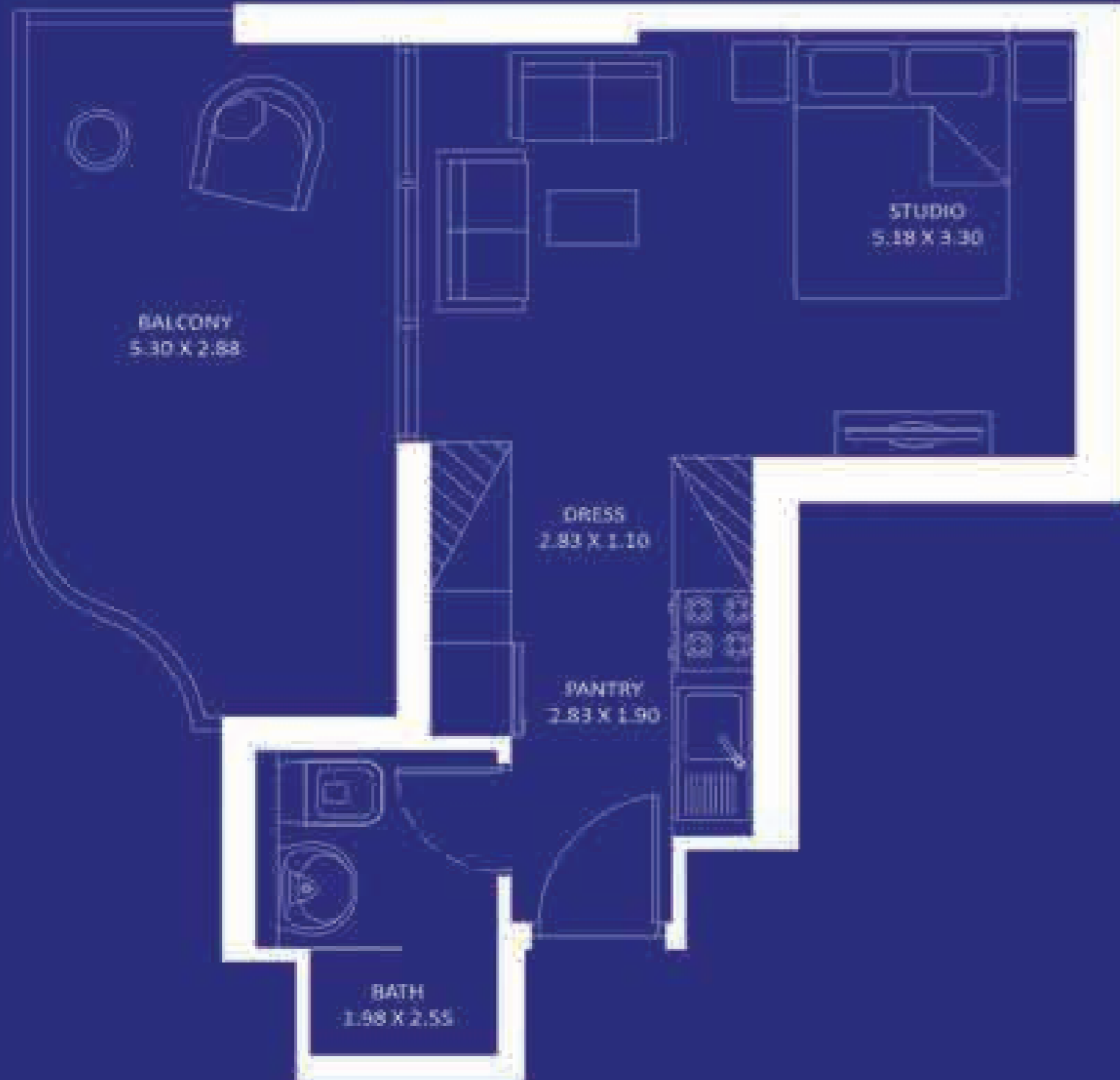

## AREA (Sq.Ft)

Apartment  
329 to 332

Balcony  
152 to 154

Total  
481 to 486

Floor

Oceanz 2

Oceanz 1



3 - 21  
6  
23 - 28



# STUDIO

TYPE - C



## AREA (Sq.Ft)

Apartment  
321 to 323

Balcony  
77 to 79

Total  
400

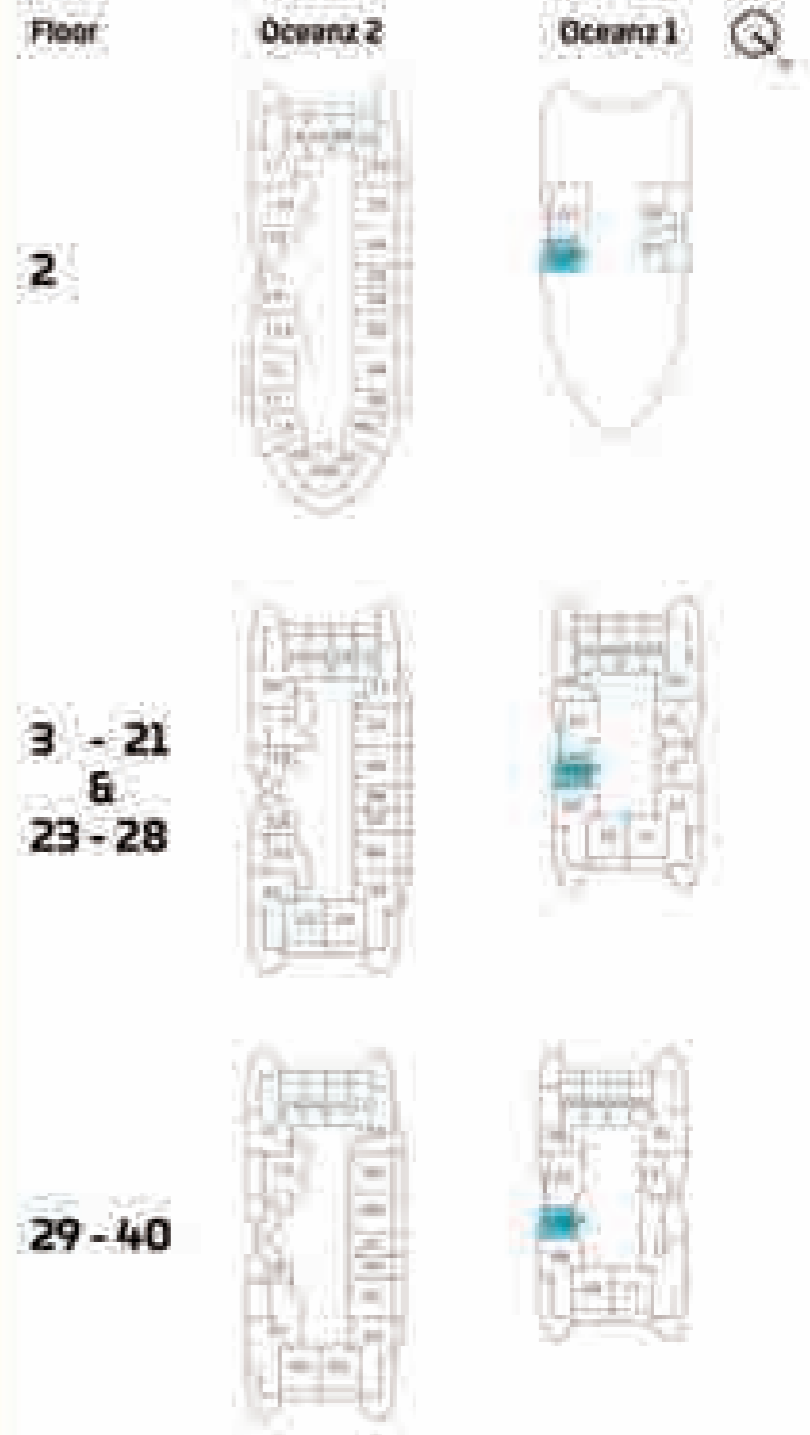

# PRESIDENTIAL STUDIO



## AREA (Sq.Ft)

Apartment  
351

Balcony  
264

Total  
615

## FEATURES :

- Pool
- Convertible 1BHK

Floor

2

3 - 21  
6  
23 - 28

29 - 40

Oceanz 2



Oceanz 1

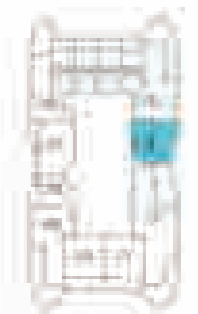
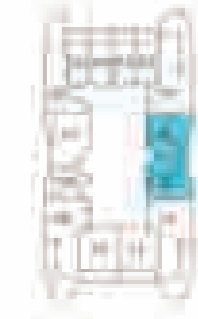
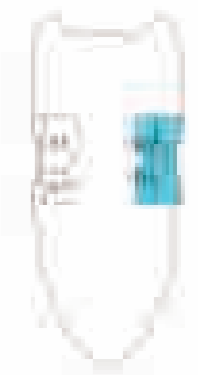

# GARDEN STUDIO



## AREA (Sq.Ft)

Apartment  
329 to 332

Balcony  
152 to 154

Total  
481 to 486

Floor

Oceanz 2

Oceanz 1



29 - 40





# 1 BEDROOM

TYPE - A

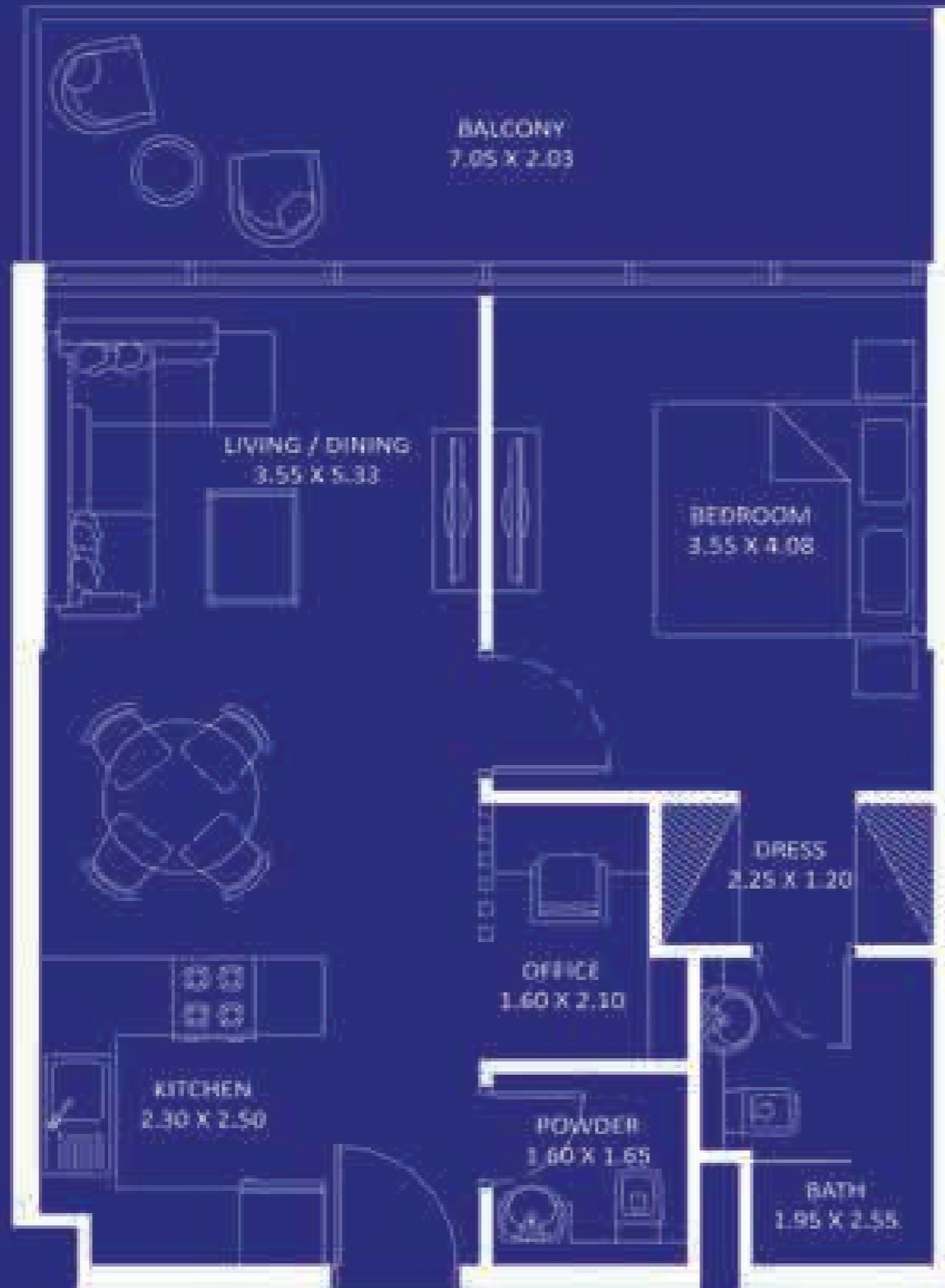

## AREA (Sq.Ft)

Apartment  
587 to 590

Balcony  
129 to 159

Total  
718 to 746

## FEATURES :

Office

Floor

Oceanz 2

Oceanz 1



1

2

3 - 21  
&  
23 - 28

22

29 - 40

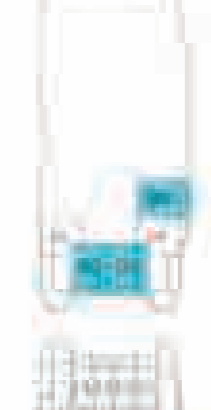
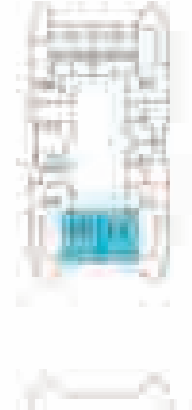
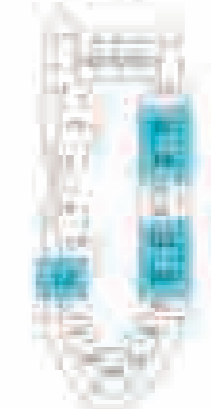
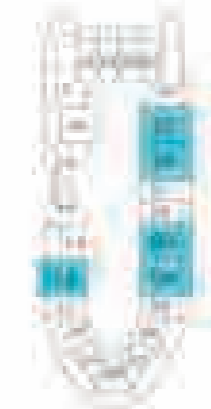

# 1 BEDROOM

TYPE - B



## AREA (Sq.Ft)

Apartment

639

Balcony

79

Total

718

## FEATURES :

Office

Floor

Oceans 2

Oceans 1



2



3 - 21

6

23 - 28



29 - 40

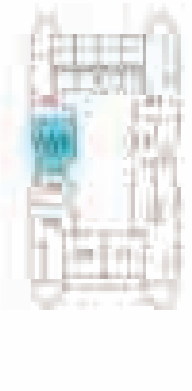

# PRESIDENTIAL SUITE - A



## AREA (Sq.Ft)

Apartment

645

Balcony

229

Total

874

## FEATURES :

- Pool
- Office

Floor

Oceanz 2

Oceanz 1



23 - 28



29 - 40



# PRESIDENTIAL SUITE - B

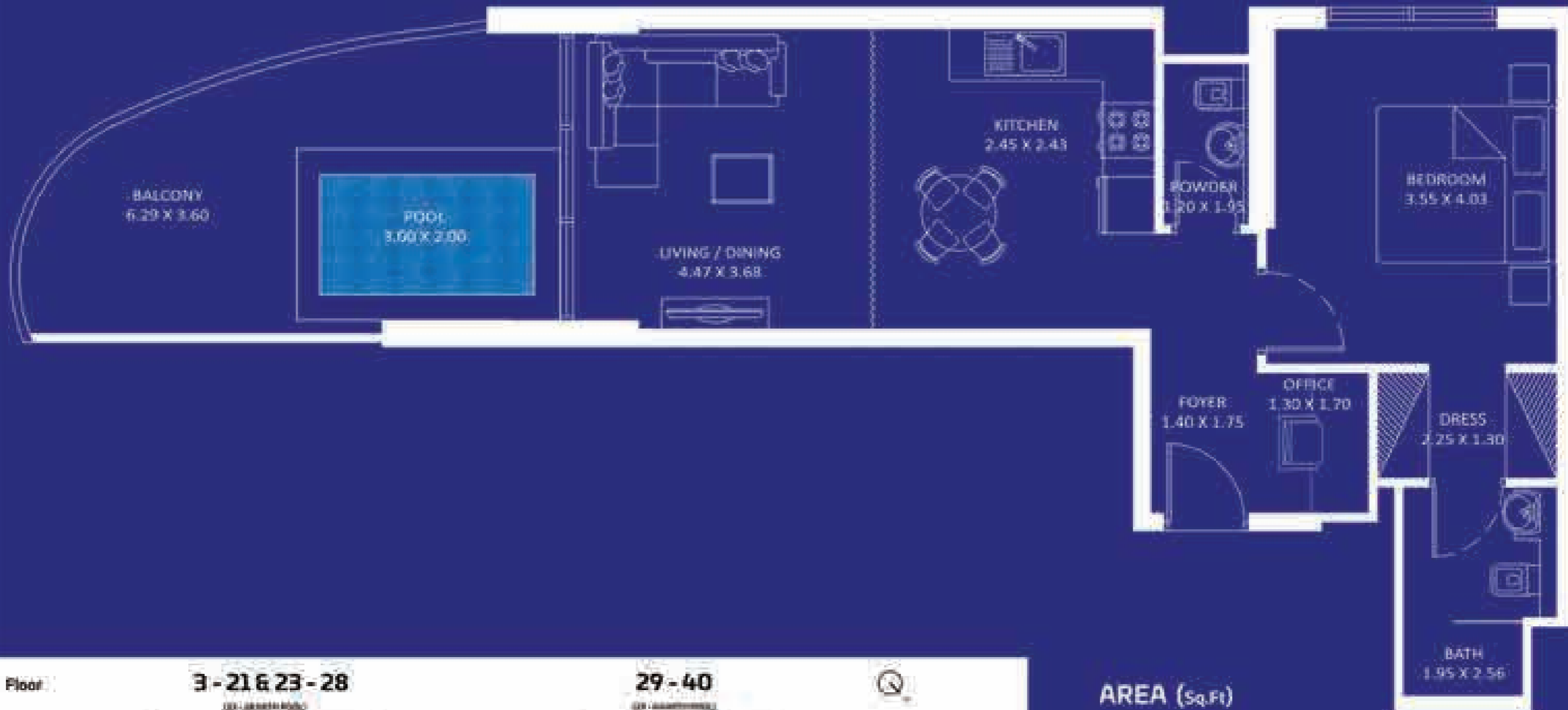

Floor :

**3 - 21 & 23 - 28**

(20 - 2000000000)

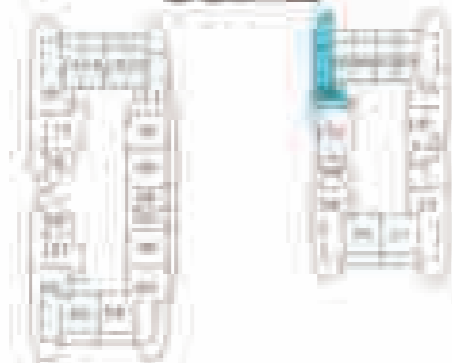

Oceanz 2

Oceanz 1

**29 - 40**

(20 - 2000000000)

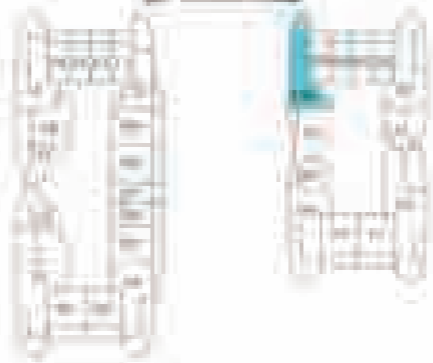

Oceanz 2

Oceanz 1



**Pool**

- 3 - 21
- 23 - 28
- 29 - 40

**AREA (Sq.Ft)**

Apartment  
**607**

Balcony  
**209**

Total  
**815**

**FEATURES :**

- Pool
- Office
- Convertible 2BHK

# PRESIDENTIAL SUITE - C

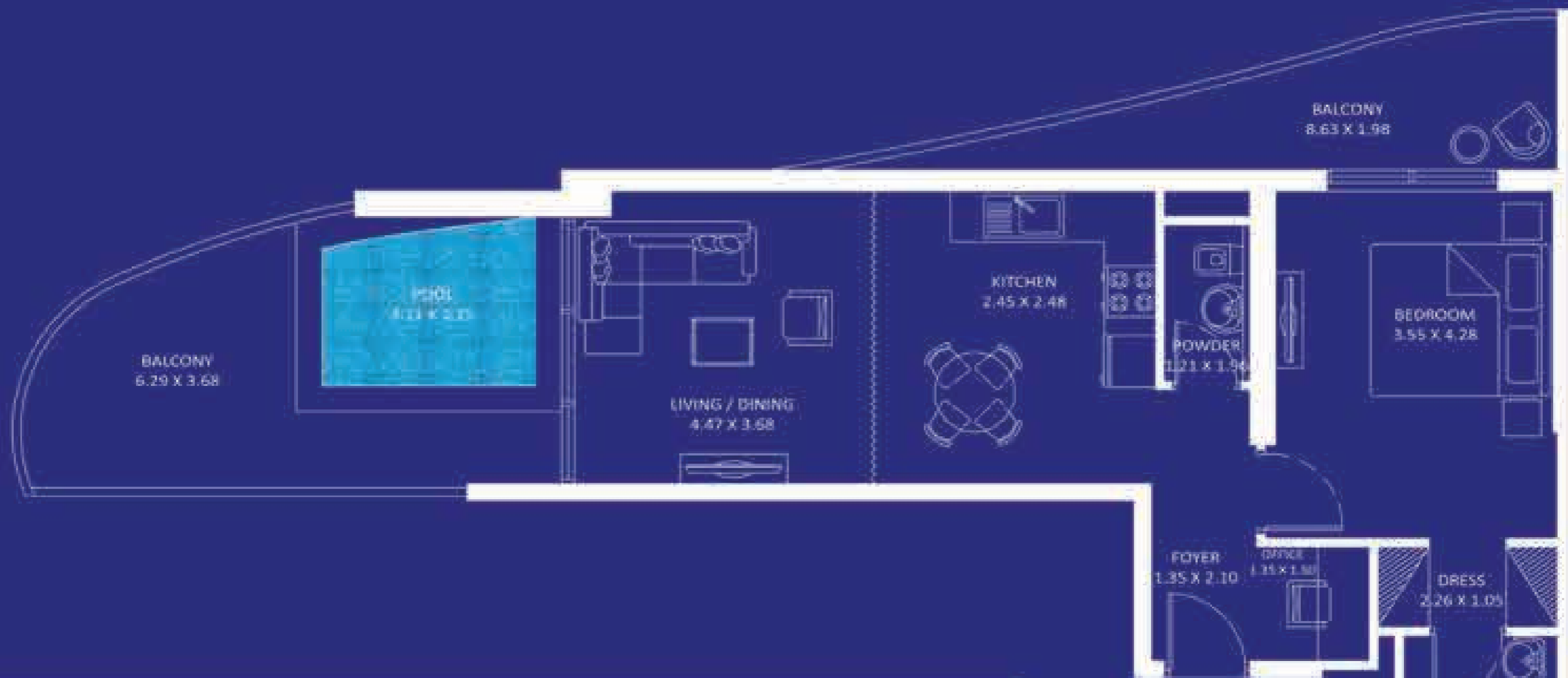

**Floor**

1 & 2 (100% POOL)	3 - 21 & 23 - 28 (80% OFFER POOL)	29 - 40 (90% OFFER POOL)	Q
Oceanz 2	Oceanz 1	Oceanz 2	Oceanz 1

**Pool**

- 1
- 2
- 3 - 21
- 23 - 28
- 29 - 40

## AREA (sq.Ft)

Apartment  
606 to 608

Balcony  
308 to 310

Total  
915 to 917

## FEATURES :

- Pool
- Office
- Convertible 2BHK

# PRESIDENTIAL SUITE - D



**AREA (Sq.Ft)**  
 Apartment  
 525 to 527  
 Balcony  
 199 to 211  
 Total  
 726 to 737

**FEATURES :**  
 Pool

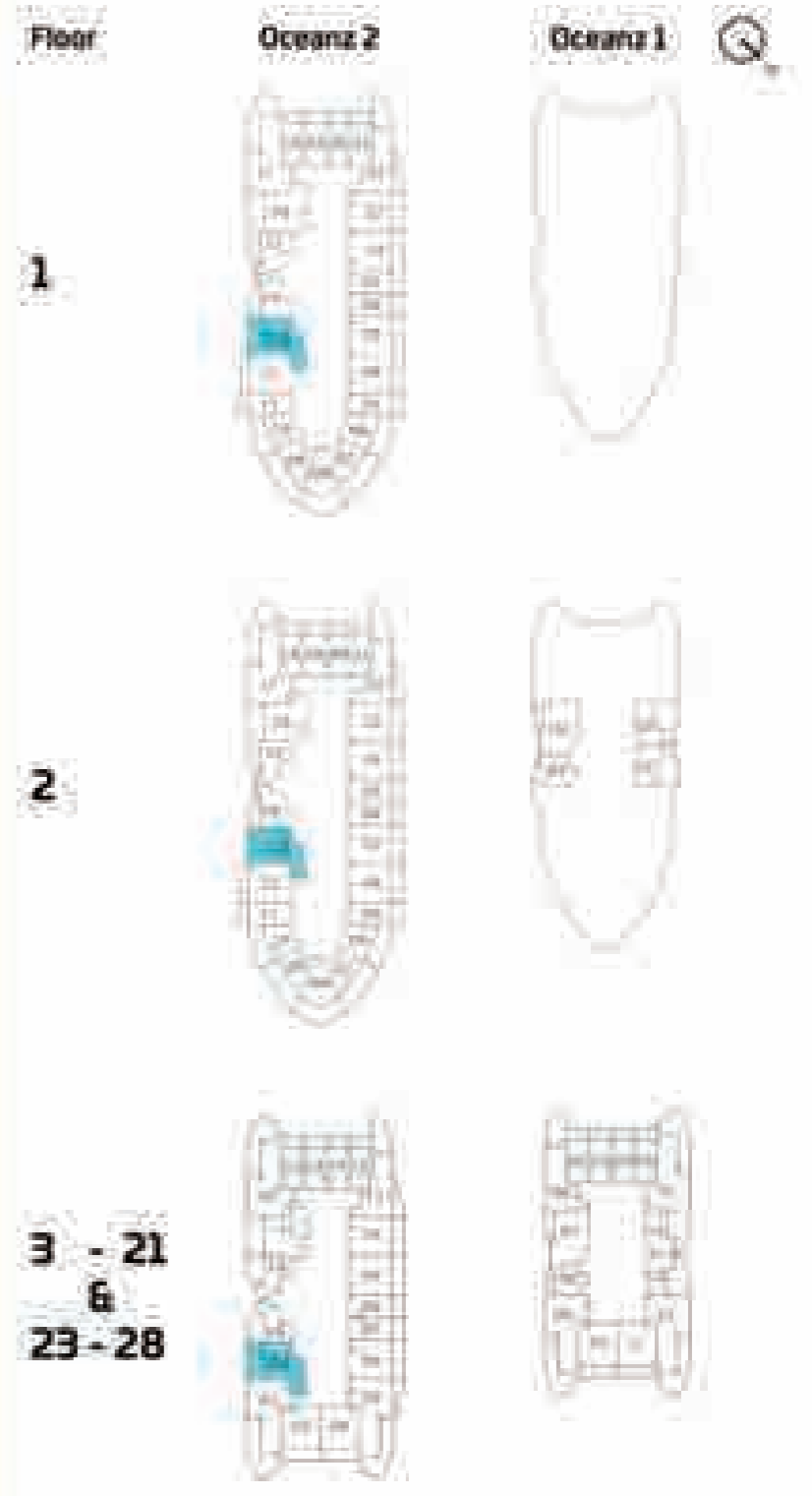

# GARDEN SUITE



## AREA (Sq.Ft)

Apartment  
644 to 645

Balcony  
228 to 229

Total  
872 to 874

## FEATURES :

Office

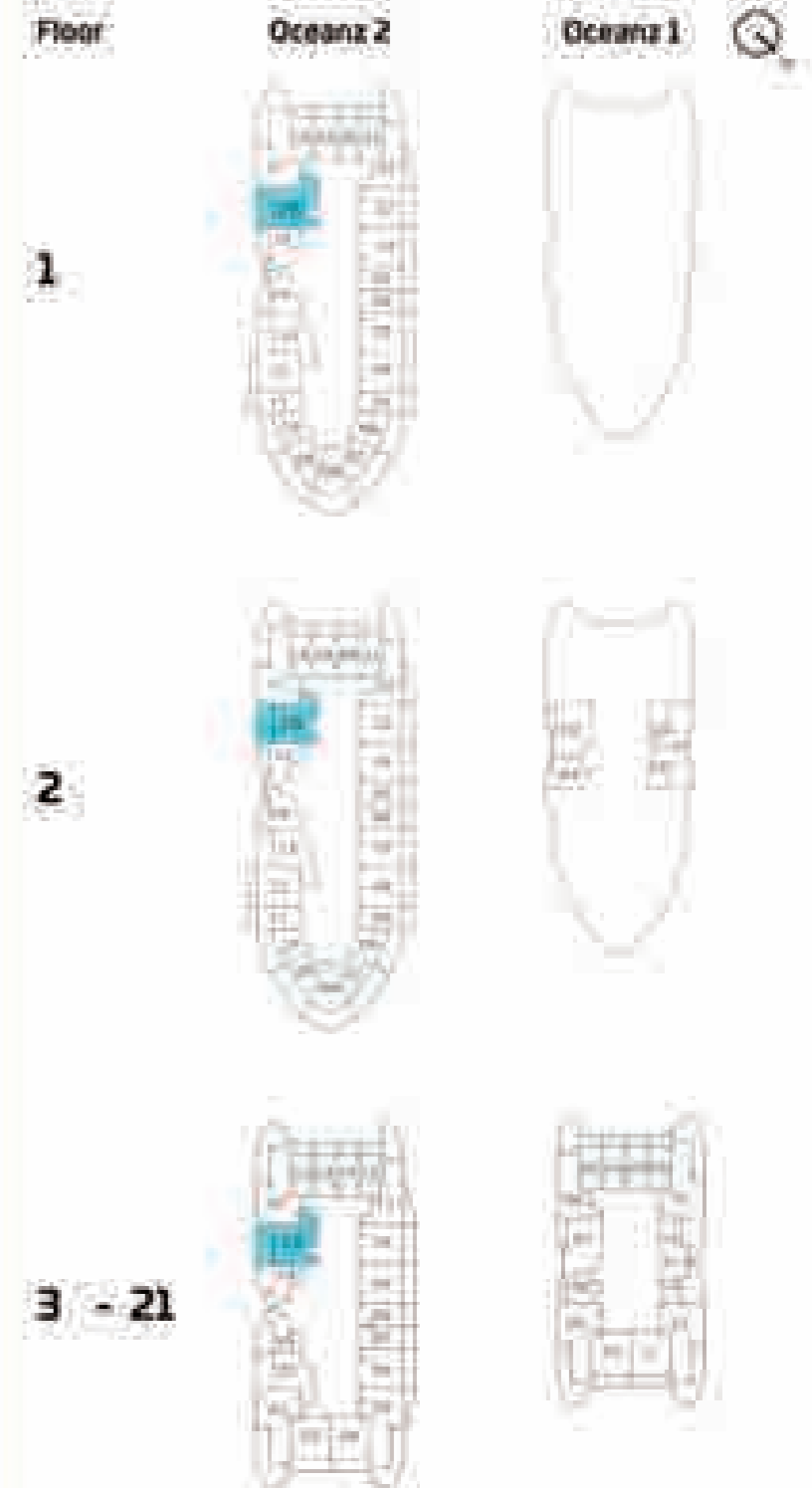

# 2 BEDROOM TYPE - A

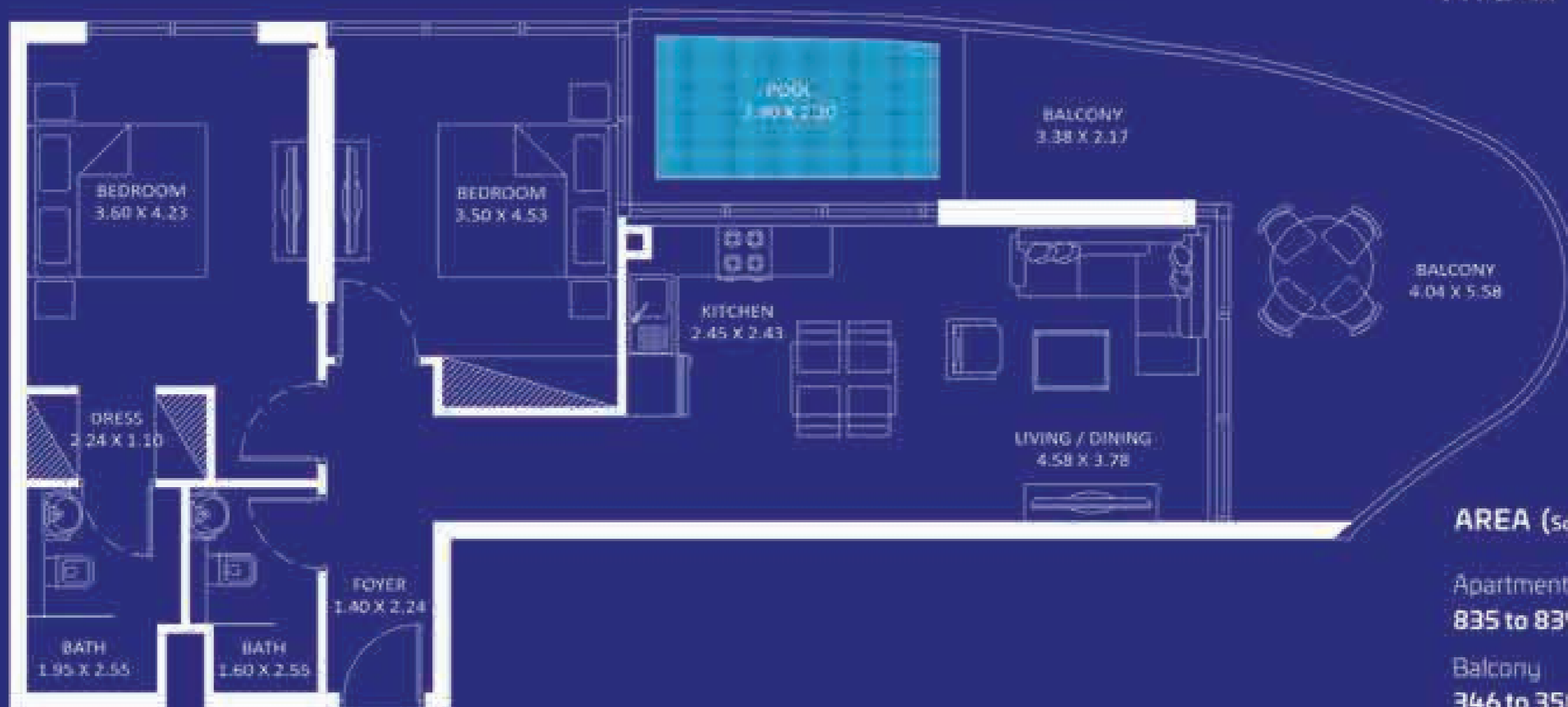

## AREA (sq.Ft)

Apartment  
835 to 839

Balcony  
346 to 350

Total  
1,184 to 1,185

## FEATURES:

Pool

Floor

1&2

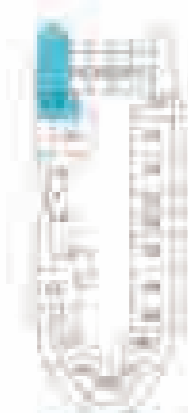

Oceanz 2



Oceanz 1

3 - 21 & 23 - 28



Oceanz 2



Oceanz 1

22



Oceanz 2



Oceanz 1

29 - 40



Oceanz 2



Oceanz 1





# 2 BEDROOM TYPE - B



**AREA (sq.Ft)**

Apartment	833
Balcony	450
<b>Total</b>	<b>1,282</b>

- FEATURES:**
- Pool



# 3 BEDROOM TYPE - A

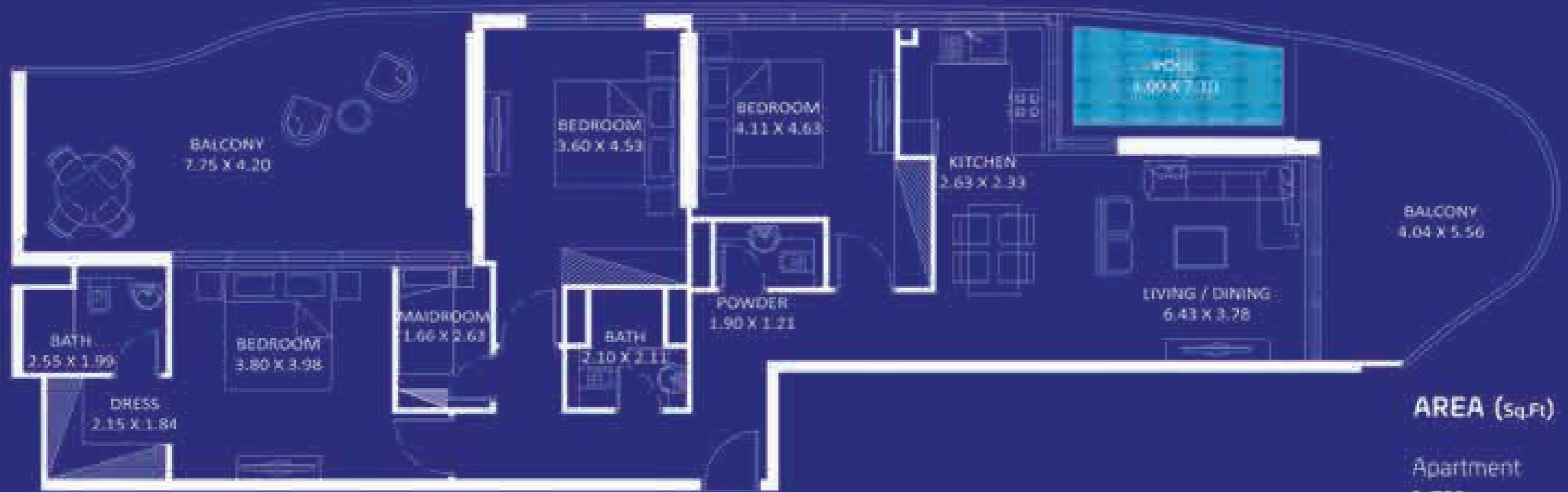

## AREA (sq.Ft)

Apartment

**1,211**

Balcony

**593**

Total

**1,804**

## FEATURES :

- Pool
- Maid Room

Floor

29 - 40



Oceanz 2



Oceanz 1



# 3 BEDROOM TYPE - B



## AREA (sq.Ft)

Apartment	1,344
Balcony	584
<b>Total</b>	<b>1,928</b>

## FEATURES :

- Pool
- Office
- Maid Room

Floor

29 - 40



Oceanz 2



Oceanz 1

**1ST FLOOR**

**3RD - 21ST  
&  
23RD - 28TH FLOOR**

**29TH - 40TH FLOOR**

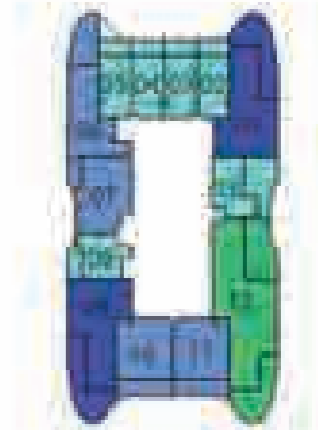
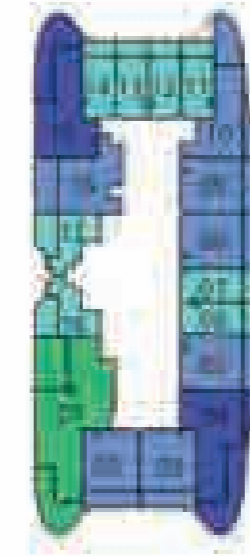
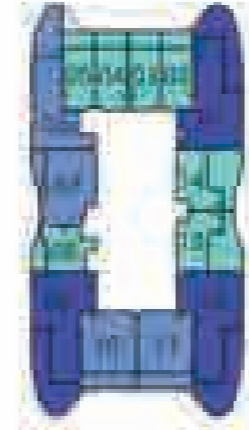
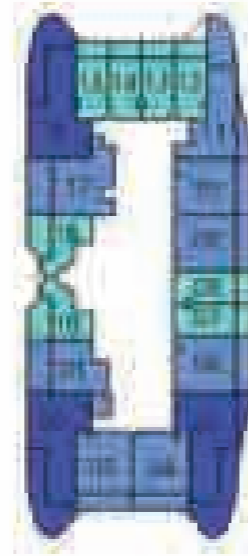
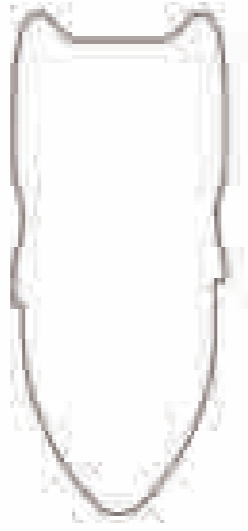
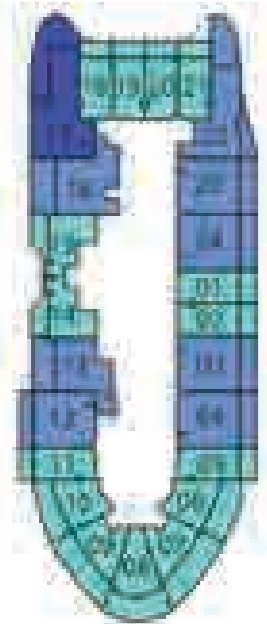

Oceanz 2

Oceanz 1

Oceanz 2

Oceanz 1

Oceanz 2

Oceanz 1

**2ND FLOOR**

**22ND FLOOR**

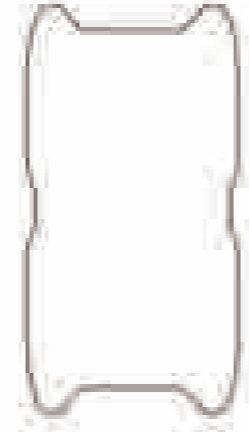
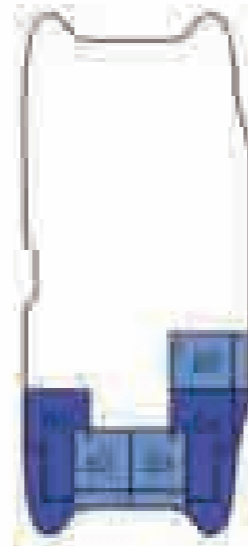
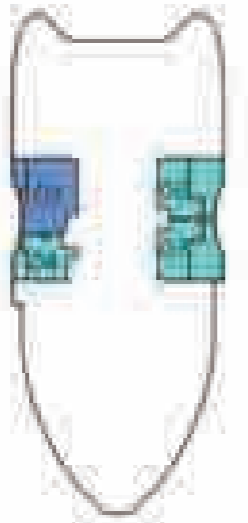
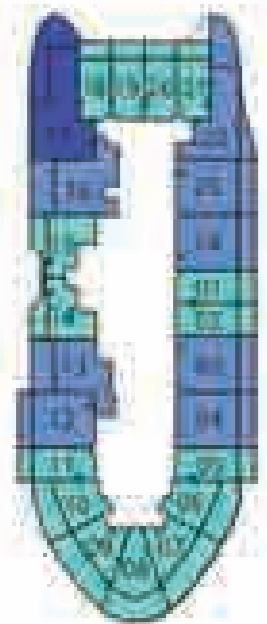

Oceanz 2

Oceanz 1

Oceanz 2

Oceanz 1

- STUDIO
- 1 BEDROOM
- 2 BEDROOM
- 3 BEDROOM





## LEGEND

1. INFINITY SWIMMING POOL
2. BEACH
3. KIDS POOL
4. KIDS SPLASH PAD
5. KIDS SHOWER AREA
6. KIDS PLAY AREA
7. TRAMPOLINE PARK
8. CRICKET PITCH
9. AQUATIC GYM
10. HEALTH BAR
11. JOGGING TRACK
12. PADDLE TENNIS
13. BASKETBALL COURT
14. TABLE TENNIS
15. CHESS BOARDS
16. SNOOKER ZONE
17. SQUASH COURT
18. SUNKEN SEATING
19. RELAXATION ZONE
20. CABANA AREA
21. SEATING AREA
22. BBQ AREA
23. OPEN CIGAR LOUNGE
24. FEMALE STEAM SAUNA
25. MALE STEAM SAUNA

## AMENITIES - FIRST FLOOR



## LEGEND

- 26. PARTY HALL
- 27. GYMNASIUM
- 28. SUNRISE DECK
- 29. OCEAN VIEWING DECK

## AMENITIES - SECOND FLOOR

## LEGEND

- 30. ROOF TOP LAZY LOUNGE
- 31. SKY JACUZZI
- 32. OCEAN CAFE
- 33. FLOATING CINEMA
- 34. AQUATIC SEATING
- 35. SUNSET DECK
- 36. MEDITATION ZONE



## AMENITIES - ROOF FLOOR



BUY | SELL | RENT | PROPERTY MANAGEMENT SERVICES

GET IN TOUCH WITH US

 **+971 56 818 8610**

 **info@homes4life.ae**

 **Head Office:**  
Office 25 | Oasis Center | Sheikh Zayed Road | Dubai | +971 4 338 7300

**Branch Office:**  
Retail 1 | Safi Apartments | Town Square Dubai | Dubai | +971 4 398 1528