

THE RESIDENCES

The 113 private Residences are comprised of varying layouts, configurations and sizes, with a unit to suit every residential need.



2 BEDROOM SIMPLEX TYPE 1

Suite Area:
163.75 m²
1,422.00 sq ft

Balcony Area:
25.53 m²
274.00 sq ft

Total Area:
157.61 m²
1,696.00 sq ft

- | | | |
|-------------------|-------------------|---------------------|
| 1. Master Bedroom | 5. Ensuite | 9. Powder Room |
| 2. Master Ensuite | 6. Maid's Bedroom | 10. Foyer |
| 3. Walk in Robe | 7. Maid's WC | 11. Show Kitchen |
| 4. Second Bedroom | 8. Balcony | 12. Living & Dining |

Keyplan

Ground Floor / 1st / 2nd / 3rd / 4th / 5th / 6th / 7th / 8th

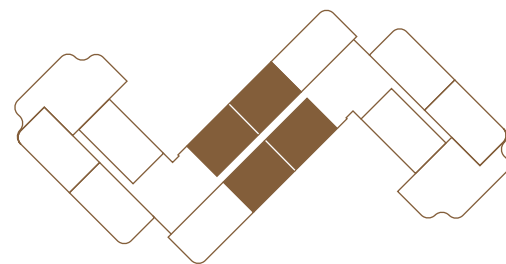

SCALE

~10 Meters

All dimensions are in imperial and metric, and measured from finish to finish excluding construction tolerances. 2. All materials, dimensions, and drawings are approximate only. 3. Information is subject to change without notice, at developer's absolute discretion. 4. Actual area may vary from the stated area. 5. Drawings not to scale. 6. All images used are for illustrative purposes only and do not represent the actual size, features, specifications, fittings, and furnishings. 7. The developer reserves the right to make revisions / alterations, at its absolute discretion, without any liability whatsoever.



2 BEDROOM SIMPLEX TYPE 2

Suite Area:
173.16 m²
1,864.00 sq ft

Balcony Area:
79.86 m²
859.00 sq ft

Total Area:
253.02 m²
2,723.00 sq ft

- | | | |
|-------------------|-------------------|---------------------|
| 1. Master Bedroom | 6. Walk in Robe | 11. Foyer |
| 2. Master Ensuite | 7. Maid's Bedroom | 12. Show Kitchen |
| 3. Walk in Robe | 8. Maid's WC | 13. Wet Kitchen |
| 4. Second Bedroom | 9. Balcony | 14. Living & Dining |
| 5. Ensuite | 10. Powder Room | |

Keyplan

Ground Floor / 1st / 2nd / 3rd / 4th / 5th / 6th / 7th / 8th

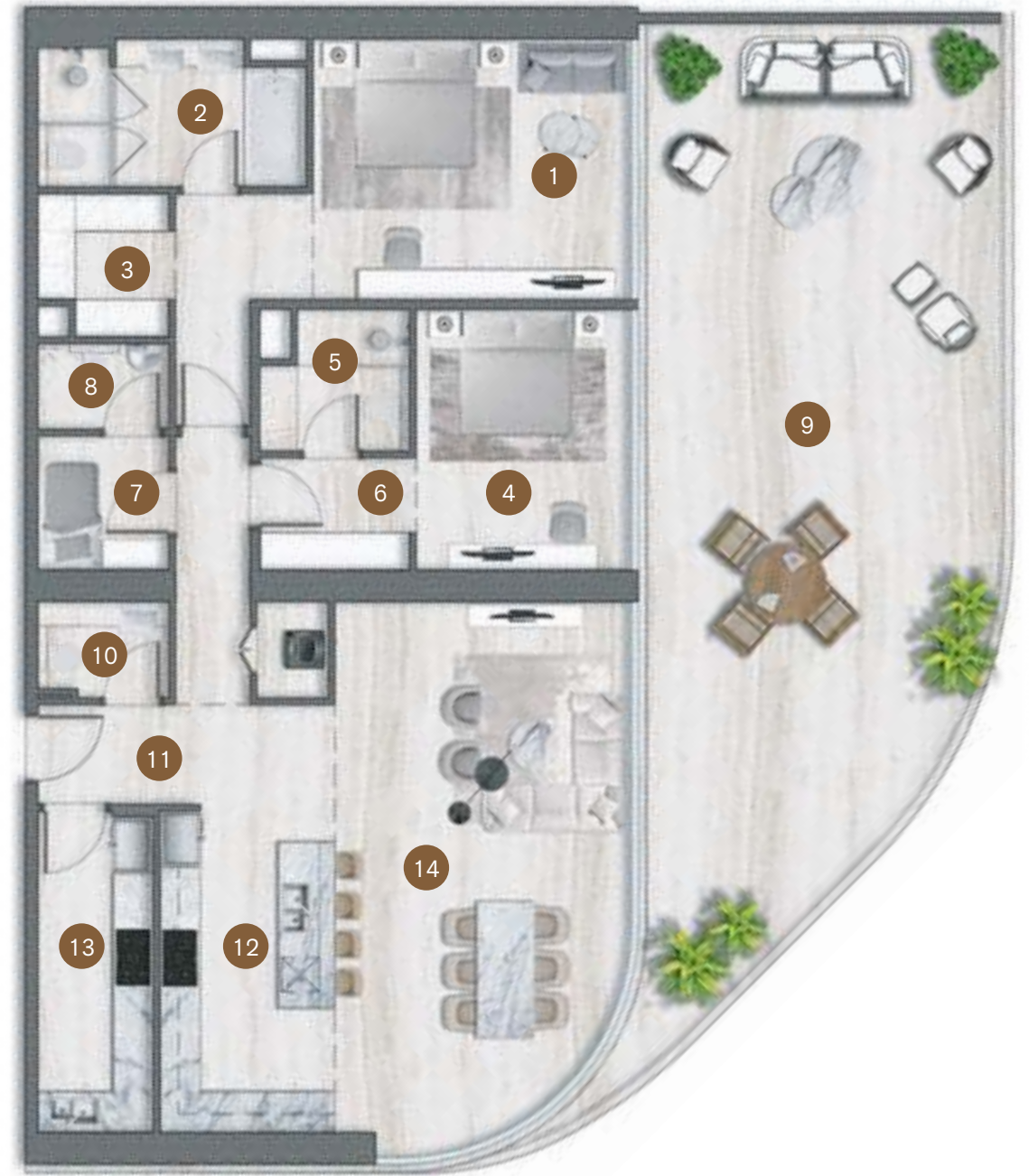
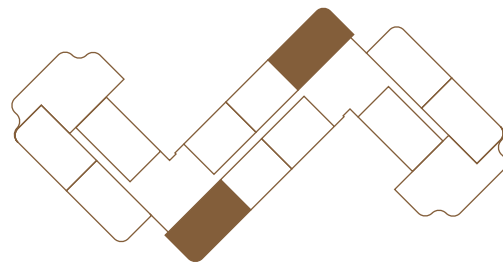

SCALE

~10 Meters

All dimensions are in imperial and metric, and measured from finish to finish excluding construction tolerances. 2. All materials, dimensions, and drawings are approximate only. 3. Information is subject to change without notice, at developer's absolute discretion. 4. Actual area may vary from the stated area. 5. Drawings not to scale. 6. All images used are for illustrative purposes only and do not represent the actual size, features, specifications, fittings, and furnishings. 7. The developer reserves the right to make revisions / alterations, at its absolute discretion, without any liability whatsoever.

3 BEDROOM SIMPLEX TYPE 1

Suite Area:
172.82 m²
1,860.00 sq ft

Balcony Area:
38.28 m²
412.00 sq ft

Total Area:
211.10 m²
2,272.00 sq ft

- | | | |
|-------------------|--------------------|--------------------------|
| 1. Master Bedroom | 7. Third Bedroom | 13. Powder Room |
| 2. Ensuite | 8. Ensuite | 14. Foyer |
| 3. Walk in Robe | 9. Wardrobes | 15. Show Kitchen |
| 4. Second Bedroom | 10. Maid's Bedroom | 16. Living & Dining Area |
| 5. Ensuite | 11. Maid's WC | 17. Terrace |
| 6. Wardrobes | 12. Laundry | |



Keyplan

Ground Floor / 1st / 2nd / 3rd / 4th / 5th / 6th / 7th / 8th

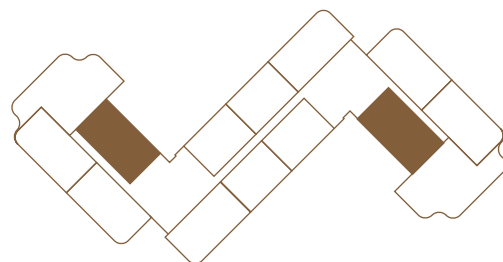

SCALE
~10 Meters

All dimensions are in imperial and metric, and measured from finish to finish excluding construction tolerances. 2. All materials, dimensions, and drawings are approximate only. 3. Information is subject to change without notice, at developer's absolute discretion. 4. Actual area may vary from the stated area. 5. Drawings not to scale. 6. All images used are for illustrative purposes only and do not represent the actual size, features, specifications, fittings, and furnishings. 7. The developer reserves the right to make revisions / alterations, at its absolute discretion, without any liability whatsoever.

3 BEDROOM SIMPLEX TYPE 2

Suite Area:
254.45 m²
2,739.00 sq ft

Balcony Area:
122.34 m²
1,317.00 sq ft

Total Area:
376.79 m²
4,056.00 sq ft

- | | | |
|-------------------|-------------------|--------------------------|
| 1. Master Bedroom | 7. Ensuite | 13. Show Kitchen |
| 2. Master Ensuite | 8. Maid's Bedroom | 14. Wet Kitchen |
| 3. Walk in Robe | 9. Maid's WC | 15. Living & Dining Area |
| 4. Second Bedroom | 10. Laundry | 16. Terrace |
| 5. Ensuite | 11. Powder Room | |
| 6. Third Bedroom | 12. Foyer | |

Keyplan
Ground Floor / 1st

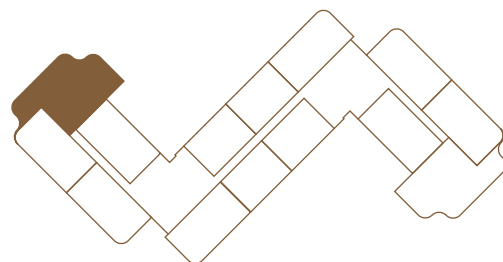

SCALE
~10 Meters

All dimensions are in imperial and metric, and measured from finish to finish excluding construction tolerances. 2. All materials, dimensions, and drawings are approximate only. 3. Information is subject to change without notice, at developer's absolute discretion. 4. Actual area may vary from the stated area. 5. Drawings not to scale. 6. All images used are for illustrative purposes only and do not represent the actual size, features, specifications, fittings, and furnishings. 7. The developer reserves the right to make revisions / alterations, at its absolute discretion, without any liability whatsoever.

3 BEDROOM DUPLIX

Suite Area:
303.72 m²
3,269.00 sq ft

Balcony Area:
86.8 m²
934.00 sq ft

Total Area:
390.52 m²
4,204.00 sq ft

Upper Level

Lower Level

1. Master Bedroom	7. Family Room	10. Wet Kitchen	17. Pool Area
2. Ensuite	8. Pantry	11. Show Kitchen & Dining	18. Maid's Bedroom
3. Walk in Robe	9. Void	12. Foyer	19. Maid's WC
4. Second Bedroom		13. Balcony	20. Laundry
5. Ensuite		14. Powder Room	21. Third Bedroom
6. Walk in Robe		15. Wash Room	22. Walk in Robe
		16. Living Area	23. Ensuite

Keyplan

Ground Floor / 2nd / 4th / 6th / 8th

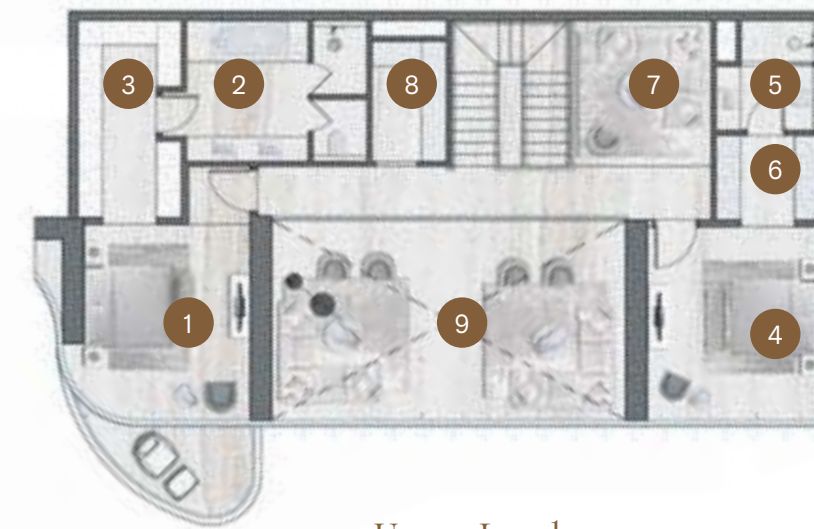
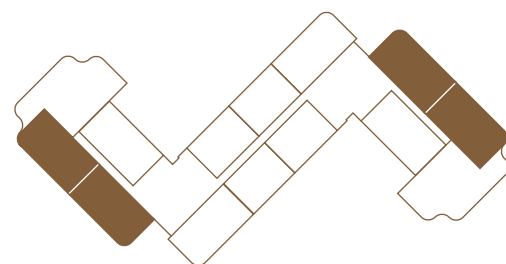

Upper Level

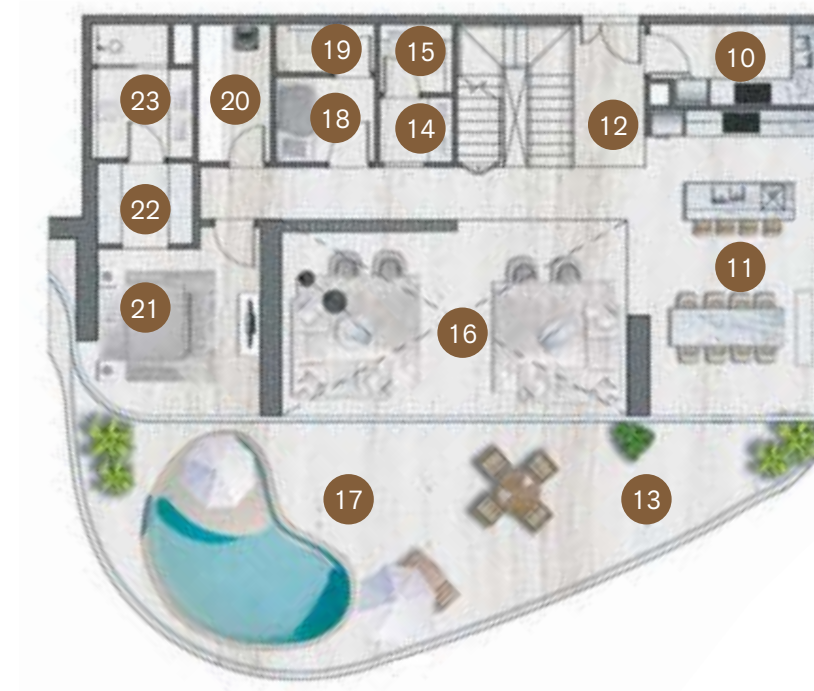

Lower Level

SCALE
~10 Meters

All dimensions are in imperial and metric, and measured from finish to finish excluding construction tolerances. 2. All materials, dimensions, and drawings are approximate only. 3. Information is subject to change without notice, at developer's absolute discretion. 4. Actual area may vary from the stated area. 5. Drawings not to scale. 6. All images used are for illustrative purposes only and do not represent the actual size, features, specifications, fittings, and furnishings. 7. The developer reserves the right to make revisions / alterations, at its absolute discretion, without any liability whatsoever.



3 BEDROOM PENTHOUSE

Suite Area:
341.95 m²
3,681.00 sq ft

Balcony Area:
269.49 m²
2,900.00 sq ft

Total Area:
611.44 m²
6,581.00 sq ft

- | | | |
|---------------------|--------------------|--------------------------|
| 1. Master Bedroom | 8. Third Bedroom | 15. Wet Kitchen |
| 2. Master Bathroom | 9. Ensuite | 16. Foyer |
| 3. Her Walk in Robe | 10. Wardrobes | 17. Show Kitchen |
| 4. His Walk in Robe | 11. Laundry | 18. Living & Dining Area |
| 5. Second Bedroom | 12. Maid's Bedroom | 19. Dining Terrace |
| 6. Ensuite | 13. Maid's WC | 20. Terrace |
| 7. Wardrobes | 14. Powder Room | 21. Shadow Pond |

Keyplan
Roof Floor

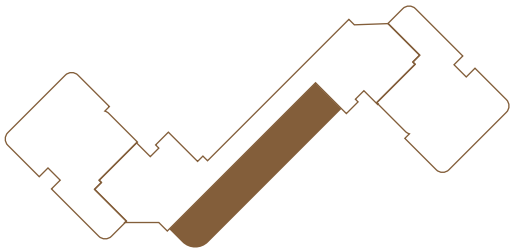

SCALE
~10 Meters

All dimensions are in imperial and metric, and measured from finish to finish excluding construction tolerances. 2. All materials, dimensions, and drawings are approximate only. 3. Information is subject to change without notice, at developer's absolute discretion. 4. Actual area may vary from the stated area. 5. Drawings not to scale. 6. All images used are for illustrative purposes only and do not represent the actual size, features, specifications, fittings, and furnishings. 7. The developer reserves the right to make revisions / alterations, at its absolute discretion, without any liability whatsoever.

4 BEDROOM DUPLEX

Suite Area:
437.41m²
4,708.00 sq ft

Balcony Area:
126.61m²
1,363.00 sq ft

Total Area:
564.02 m²
6,071.00 sq ft

Upper Level

- 1. Master Bedroom
- 2. Ensuite
- 3. Her Walk In Robe
- 4. His Walk In Robe
- 5. Second Bedroom
- 6. Ensuite
- 7. Wardrobes

- 8. Third Bedroom
- 9. Ensuite
- 10. Balcony

- 11. Fourth Bedroom
- 12. Ensuite
- 13. Walk in Robe
- 14. Maid's Bedroom
- 15. Maid's WC
- 16. Laundry
- 17. Pantry
- 18. Utility

- 19. Foyer
- 20. Powder Room
- 21. Wet Kitchen
- 22. Show Kitchen
- 23. Dining Area
- 24. Living Room
- 25. Balcony
- 26. Pool Area

Keyplan

Ground Floor / 2nd / 4th / 6th / 8th

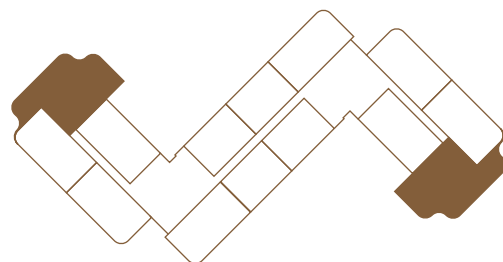

Upper Level



Lower Level

SCALE

~10 Meters

All dimensions are in imperial and metric, and measured from finish to finish excluding construction tolerances. 2. All materials, dimensions, and drawings are approximate only. 3. Information is subject to change without notice, at developer's absolute discretion. 4. Actual area may vary from the stated area. 5. Drawings not to scale. 6. All images used are for illustrative purposes only and do not represent the actual size, features, specifications, fittings, and furnishings. 7. The developer reserves the right to make revisions / alterations, at its absolute discretion, without any liability whatsoever.

4 BEDROOM PENTHOUSE

Suite Area:
344.74 m²
3,711.00 sq ft

Balcony Area:
952.36 m²
10,251.00 sq ft

Total Area:
1297.10 m²
13,962.00 sq ft

- | | | |
|---------------------------|-----------------------|------------------------------|
| 1. Master Bedroom | 9. Ensuite & Wardrobe | 17. Foyer |
| 2. Ensuite | 10. Maid's Bedroom | 18. Dining & Show Kitchen |
| 3. His & Her Walk in Robe | 11. Maid's WC | 19. Living Area |
| 4. Second Bedroom | 12. Laundry | 20. Terrace Seating |
| 5. Ensuite & Wardrobe | 13. Wet Kitchen | 21. Terrace |
| 6. Third Bedroom | 14. Courtyard | 22. Fire Pit |
| 7. Ensuite & Wardrobe | 15. Family Room | 23. Terrace Dining Area |
| 8. Fourth Bedroom | 16. Powder Room | 24. Sun Loungers & Pool Area |

Keyplan
Roof Floor

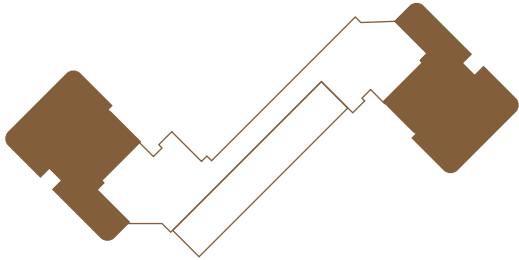

SCALE
~10 Meters

All dimensions are in imperial and metric, and measured from finish to finish excluding construction tolerances. 2. All materials, dimensions, and drawings are approximate only. 3. Information is subject to change without notice, at developer's absolute discretion. 4. Actual area may vary from the stated area. 5. Drawings not to scale. 6. All images used are for illustrative purposes only and do not represent the actual size, features, specifications, fittings, and furnishings. 7. The developer reserves the right to make revisions / alterations, at its absolute discretion, without any liability whatsoever.



BUY | SELL | RENT | PROPERTY MANAGEMENT SERVICES

GET IN TOUCH WITH US

 **+971 56 818 8610**

 **info@homes4life.ae**

 **Head Office:**
Office 25 | Oasis Center | Sheikh Zayed Road | Dubai | +971 4 338 7300

Branch Office:
Retail 1 | Safi Apartments | Town Square Dubai | Dubai | +971 4 398 1528