

# GOLF HILLSIDE

DUBAI HILLS ESTATE

---

FLOOR PLAN

---

EMAAR

# GOLF HILLSIDE

DUBAI HILLS ESTATE

## 1 BEDROOM TYPE A1

### UNITS

209, 309, 409, 509, 609, 709, 809, 909, 1009,  
1109, 1209, 1309, 1409, 1509, 1609, 1709, 1809,  
1909, 2009

SUITE AREA	624.41 SQ.FT.	58.01 SQ.M.
BALCONY AREA	116.90 SQ.FT.	10.86 SQ.M.
TOTAL AREA	741.31 SQ.FT.	68.87 SQ.M.

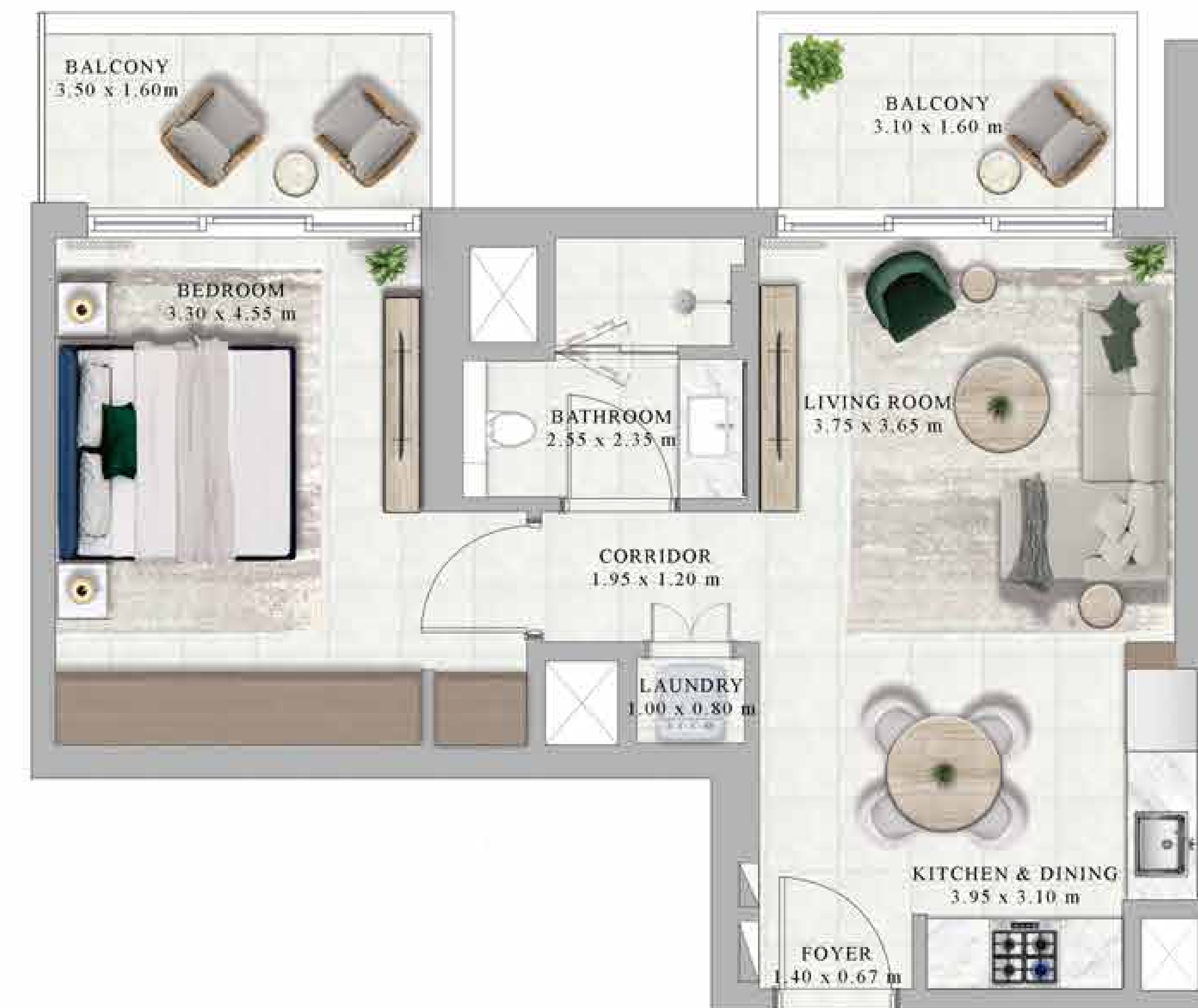

### KEY SECTION

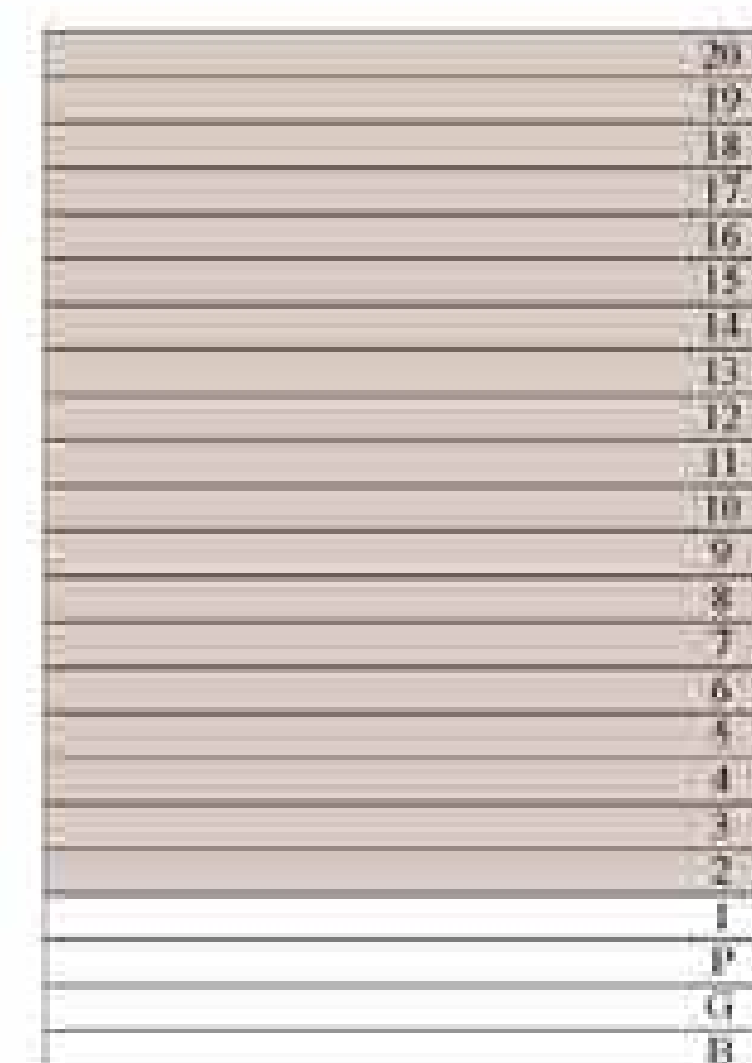

### KEY PLANS



LEVEL 2 TO 20

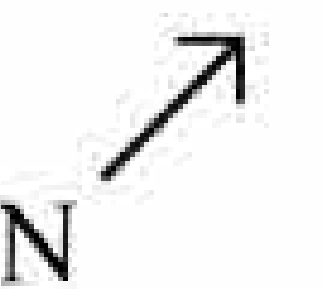

FLOOR PLAN 1. All dimensions are in imperial and metric, and measured from finish to finish excluding construction tolerances. 2. All materials, dimensions, and drawings are approximate only. 3. Information is subject to change without notice, at developer's absolute discretion. 4. Actual area may vary from the stated area. 5. Drawings not to scale. 6. All images used are for illustrative purposes only and do not represent the actual size, features, specifications, fittings, and furnishings. 7. The developer reserves the right to make revisions / alterations, at it's absolute discretion, without any liability whatsoever.

EMAAR

# GOLF HILLSIDE

DUBAI HILLS ESTATE

## 1 BEDROOM TYPE A2

### UNITS

201, 301, 401, 501, 601, 701, 801, 901, 1001,  
1101, 1201, 1301, 1401, 1501, 1601, 1701, 1801  
1901, 2001

SUITE AREA	629.26 SQ.FT.	58.46 SQ.M.
BALCONY AREA	116.90 SQ.FT.	10.86 SQ.M.
TOTAL AREA	746.15 SQ.FT.	69.32 SQ.M.



### KEY SECTION

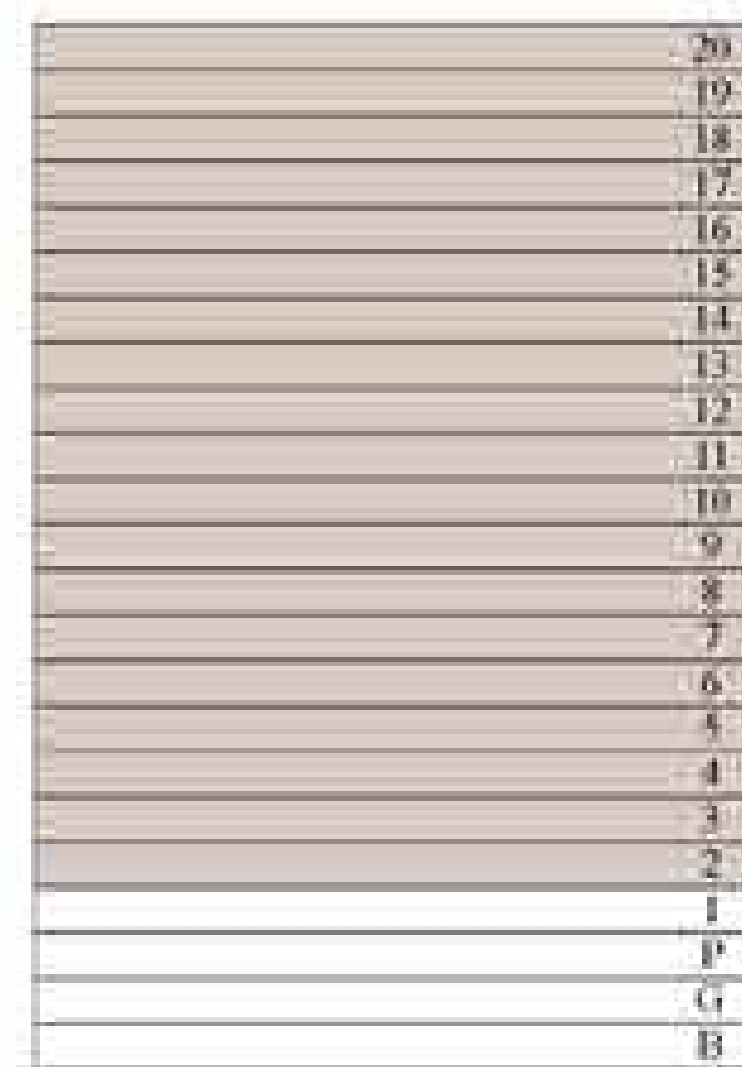

### KEY PLANS

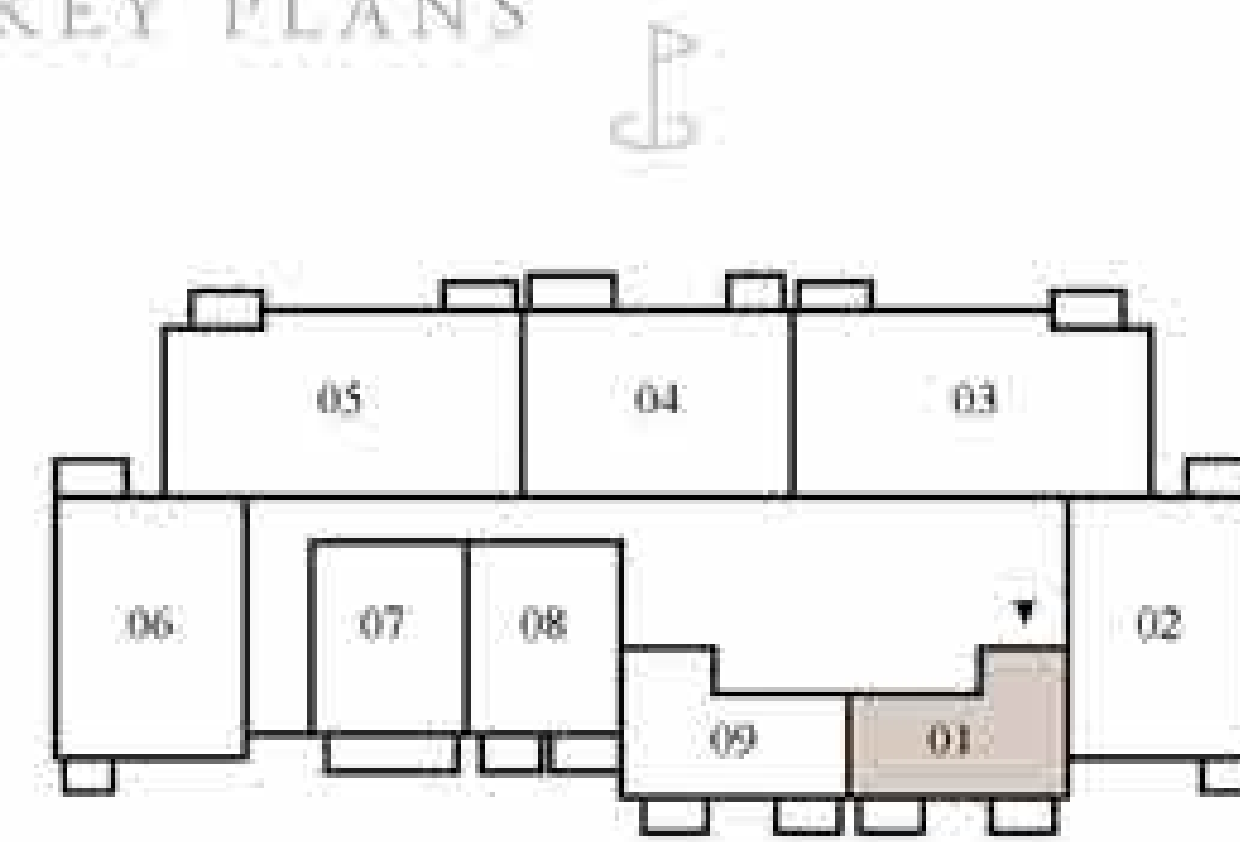

LEVEL 2 TO 20

FLOOR PLAN 1. All dimensions are in imperial and metric, and measured from finish to finish excluding construction tolerances. 2. All materials, dimensions, and drawings are approximate only. 3. Information is subject to change without notice, at developer's absolute discretion. 4. Actual area may vary from the stated area. 5. Drawings not to scale. 6. All images used are for illustrative purposes only and do not represent the actual size, features, specifications, fittings, and furnishings. 7. The developer reserves the right to make revisions / alterations, at it's absolute discretion, without any liability whatsoever.



EMAAR

# GOLF HILLSIDE

DUBAI HILLS ESTATE

## 1 BEDROOM TYPE B1

UNITS

107

SUITE AREA	696.21 SQ.FT.	64.68 SQ.M.
BALCONY AREA	285.35 SQ.FT.	26.51 SQ.M.
TOTAL AREA	981.56 SQ.FT.	91.19 SQ.M.

### KEY SECTION

20
19
18
17
16
15
14
13
12
11
10
9
8
7
6
5
4
3
2
1
P
G
B

### KEY PLANS

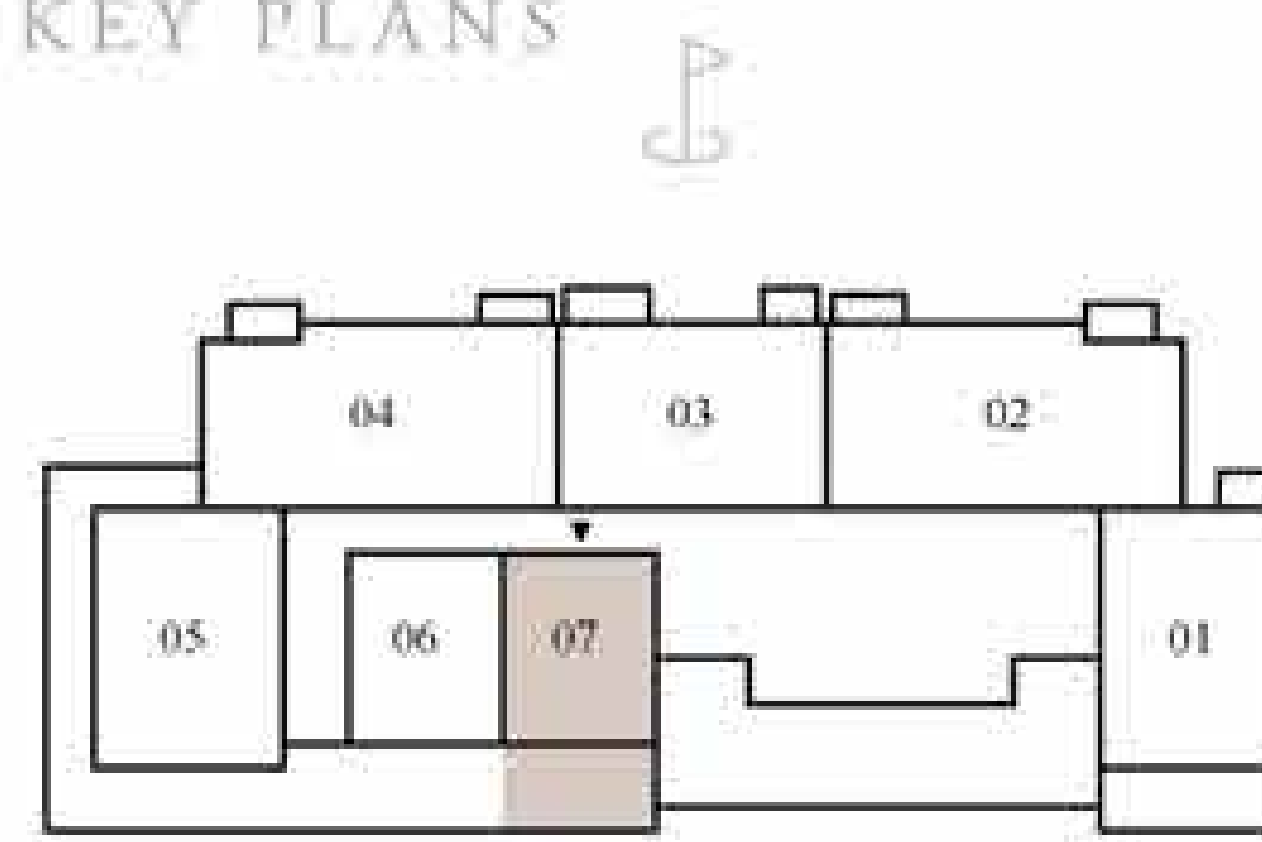

LEVEL 1

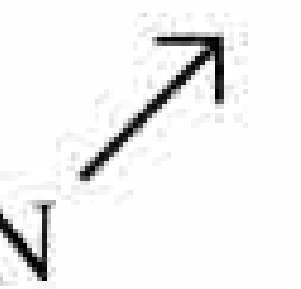
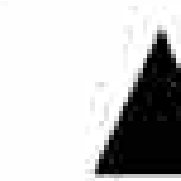

FLOOR PLAN 1. All dimensions are in imperial and metric, and measured from finish to finish excluding construction tolerances. 2. All materials, dimensions, and drawings are approximate only. 3. Information is subject to change without notice, at developer's absolute discretion. 4. Actual area may vary from the stated area. 5. Drawings not to scale. 6. All images used are for illustrative purposes only and do not represent the actual size, features, specifications, fittings, and furnishings. 7. The developer reserves the right to make revisions / alterations, at it's absolute discretion, without any liability whatsoever.

# GOLF HILLSIDE

DUBAI HILLS ESTATE

## 1 BEDROOM TYPE B2

UNITS

106

SUITE AREA	702.24 SQ.FT.	65.24 SQ.M.
BALCONY AREA	403.86 SQ.FT.	37.52 SQ.M.
TOTAL AREA	1106.10 SQ.FT.	102.76 SQ.M.

### KEY SECTION



### KEY PLANS

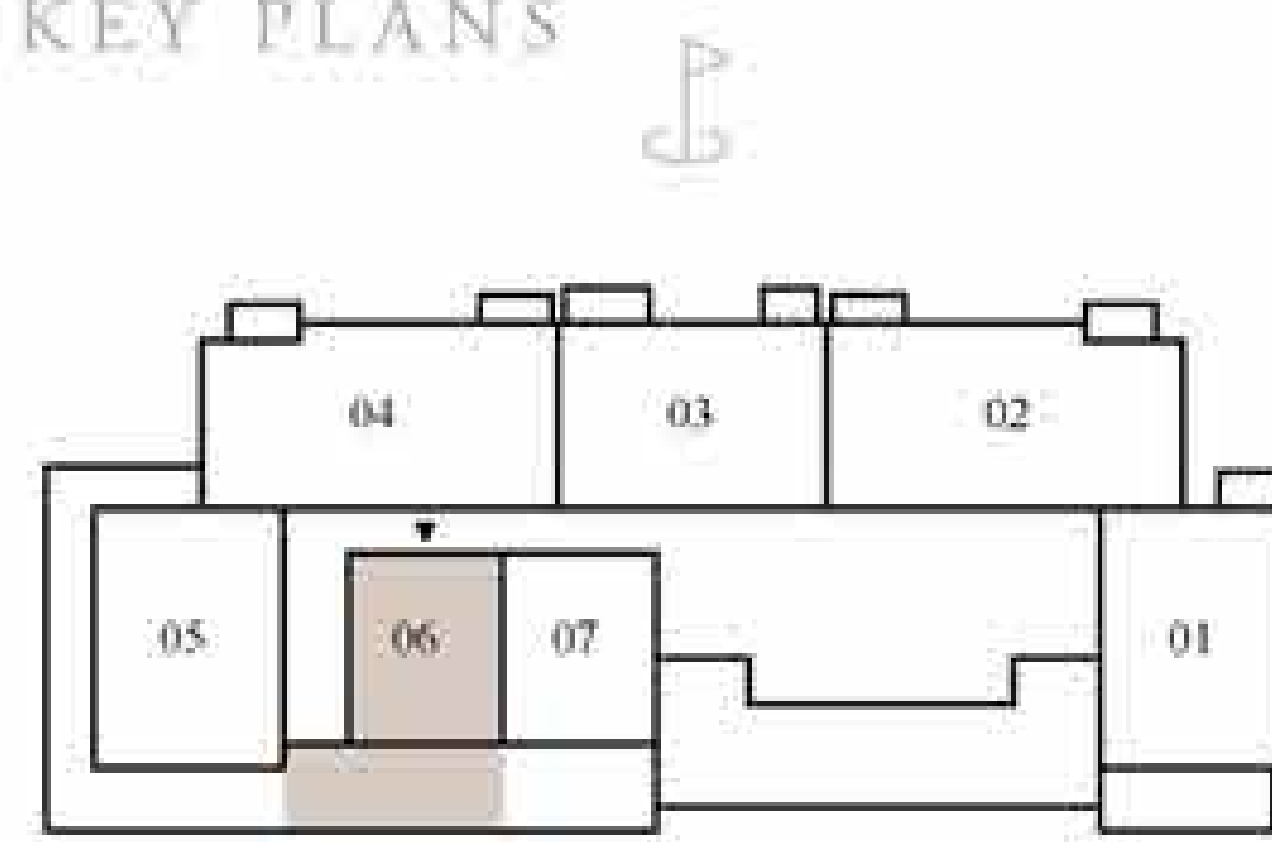

LEVEL 1

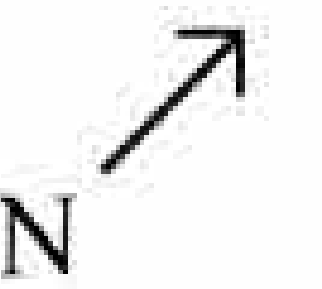
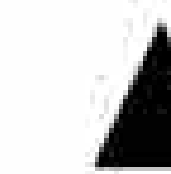

FLOOR PLAN 1. All dimensions are in imperial and metric, and measured from finish to finish excluding construction tolerances. 2. All materials, dimensions, and drawings are approximate only. 3. Information is subject to change without notice, at developer's absolute discretion. 4. Actual area may vary from the stated area. 5. Drawings not to scale. 6. All images used are for illustrative purposes only and do not represent the actual size, features, specifications, fittings, and furnishings. 7. The developer reserves the right to make revisions / alterations, at it's absolute discretion, without any liability whatsoever.

# GOLF HILLSIDE

DUBAI HILLS ESTATE

## 1 BEDROOM TYPE B3

### UNITS

208, 308, 408, 508, 608, 708, 808, 908, 1008,  
1108, 1208, 1308, 1408, 1508, 1608, 1708, 1808  
1908, 2008

SUITE AREA	696.21 SQ.FT.	64.68 SQ.M.
BALCONY AREA	109.79 SQ.FT.	10.20 SQ.M.
TOTAL AREA	806 SQ.FT.	74.88 SQ.M.

### KEY SECTION

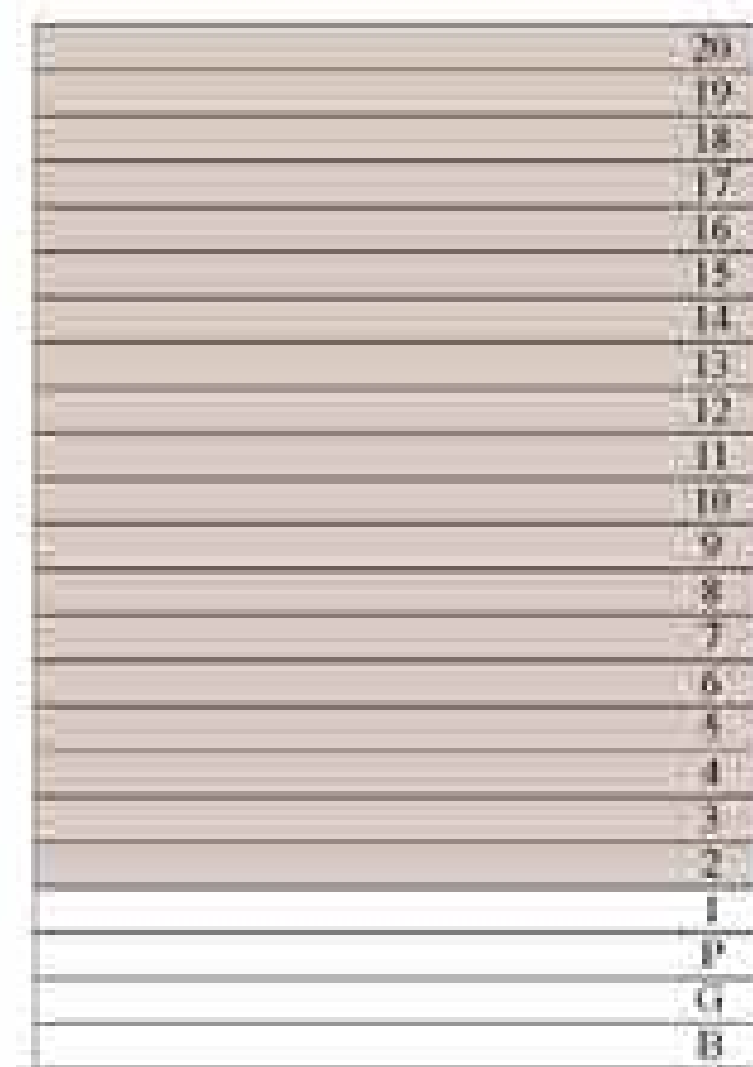

### KEY PLANS

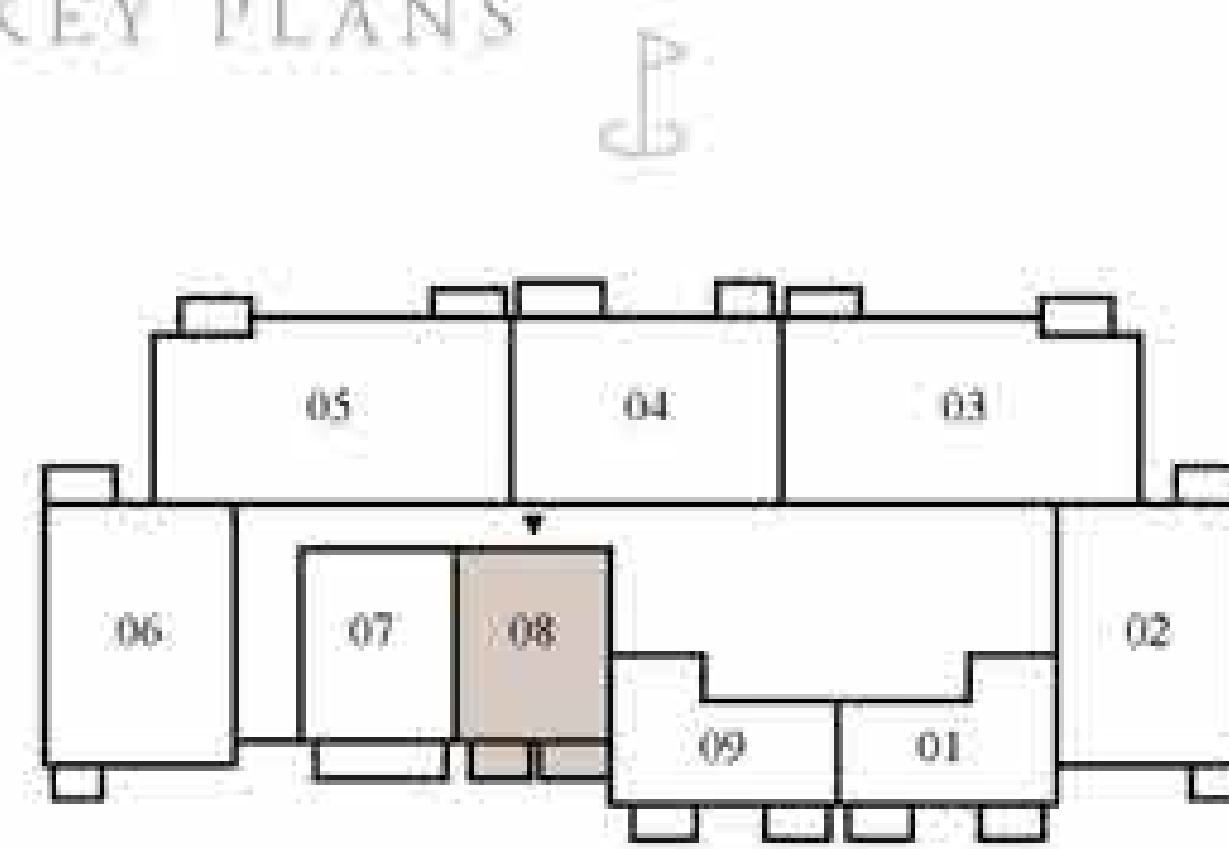

LEVEL 2 TO 20

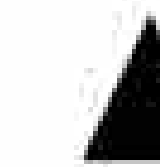

FLOOR PLAN 1. All dimensions are in imperial and metric, and measured from finish to finish excluding construction tolerances. 2. All materials, dimensions, and drawings are approximate only. 3. Information is subject to change without notice, at developer's absolute discretion. 4. Actual area may vary from the stated area. 5. Drawings not to scale. 6. All images used are for illustrative purposes only and do not represent the actual size, features, specifications, fittings, and furnishings. 7. The developer reserves the right to make revisions / alterations, at it's absolute discretion, without any liability whatsoever.

# GOLF HILLSIDE

DUBAI HILLS ESTATE

## 1 BEDROOM TYPE B4

### UNITS

207, 307, 407, 507, 607, 707, 807, 907, 1007,  
1107, 1207, 1307, 1407, 1507, 1607, 1707, 1807,  
1907, 2007

SUITE AREA	702.24 SQ.FT.	65.24 SQ.M.
BALCONY AREA	110.55 SQ.FT.	10.27 SQ.M.
TOTAL AREA	812.78 SQ.FT.	75.51 SQ.M.

### KEY SECTION

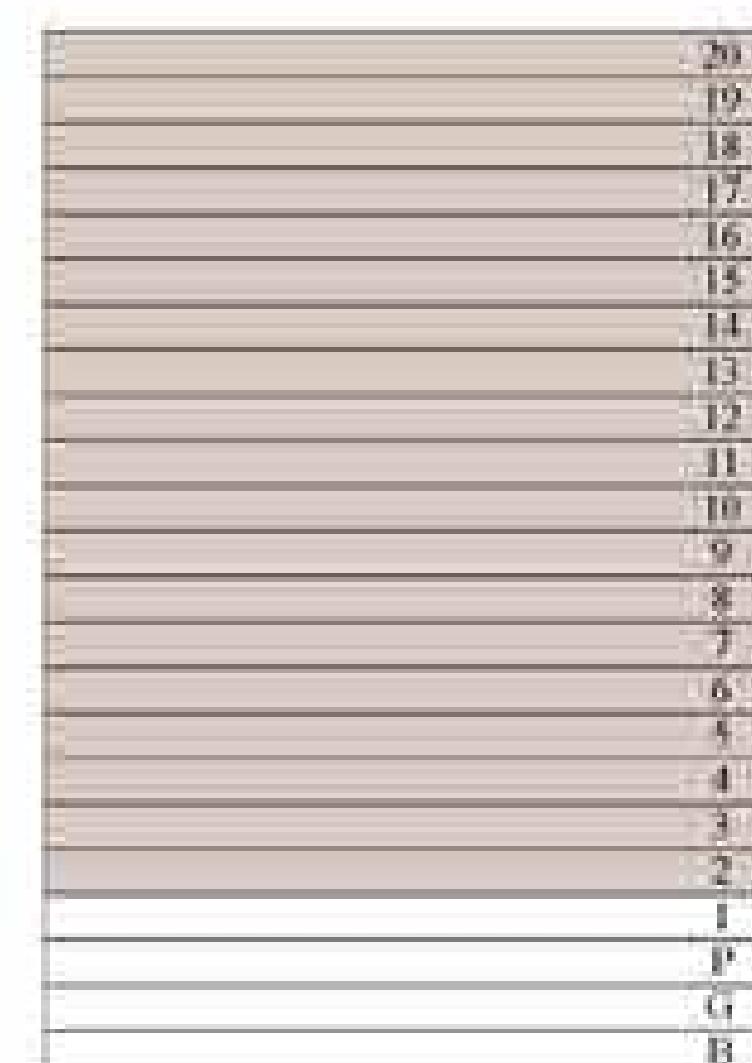

### KEY PLANS

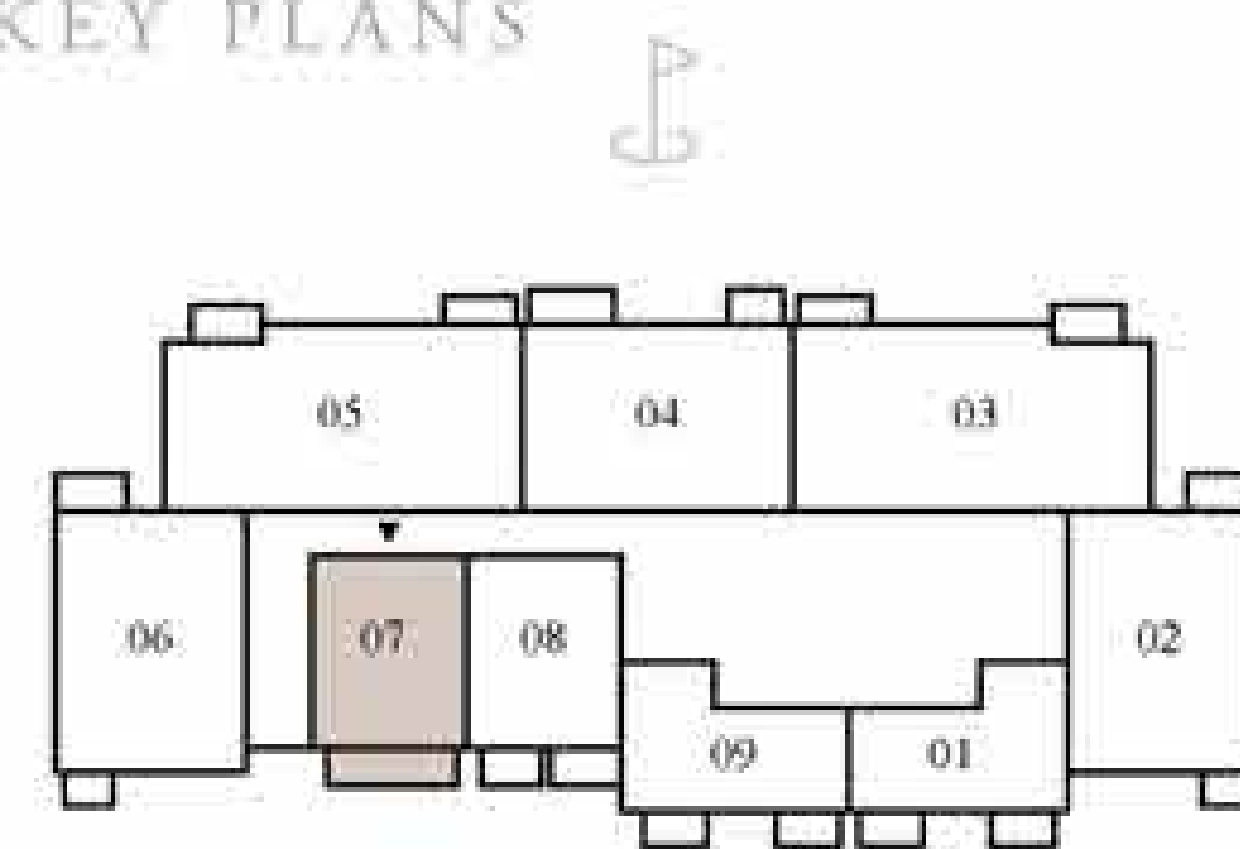

LEVEL 2 TO 20



FLOOR PLAN 1. All dimensions are in imperial and metric, and measured from finish to finish excluding construction tolerances. 2. All materials, dimensions, and drawings are approximate only. 3. Information is subject to change without notice, at developer's absolute discretion. 4. Actual area may vary from the stated area. 5. Drawings not to scale. 6. All images used are for illustrative purposes only and do not represent the actual size, features, specifications, fittings, and furnishings. 7. The developer reserves the right to make revisions / alterations, at it's absolute discretion, without any liability whatsoever.

# GOLF HILLSIDE

DUBAI HILLS ESTATE

## 2 BEDROOM TYPE A1

UNITS  
101

SUITE AREA	1095.01 SQ.FT.	101.73 SQ.M.
BALCONY AREA	299.88 SQ.FT.	27.86 SQ.M.
TOTAL AREA	1394.90 SQ.FT.	129.59 SQ.M.



### KEY SECTION



### KEY PLANS

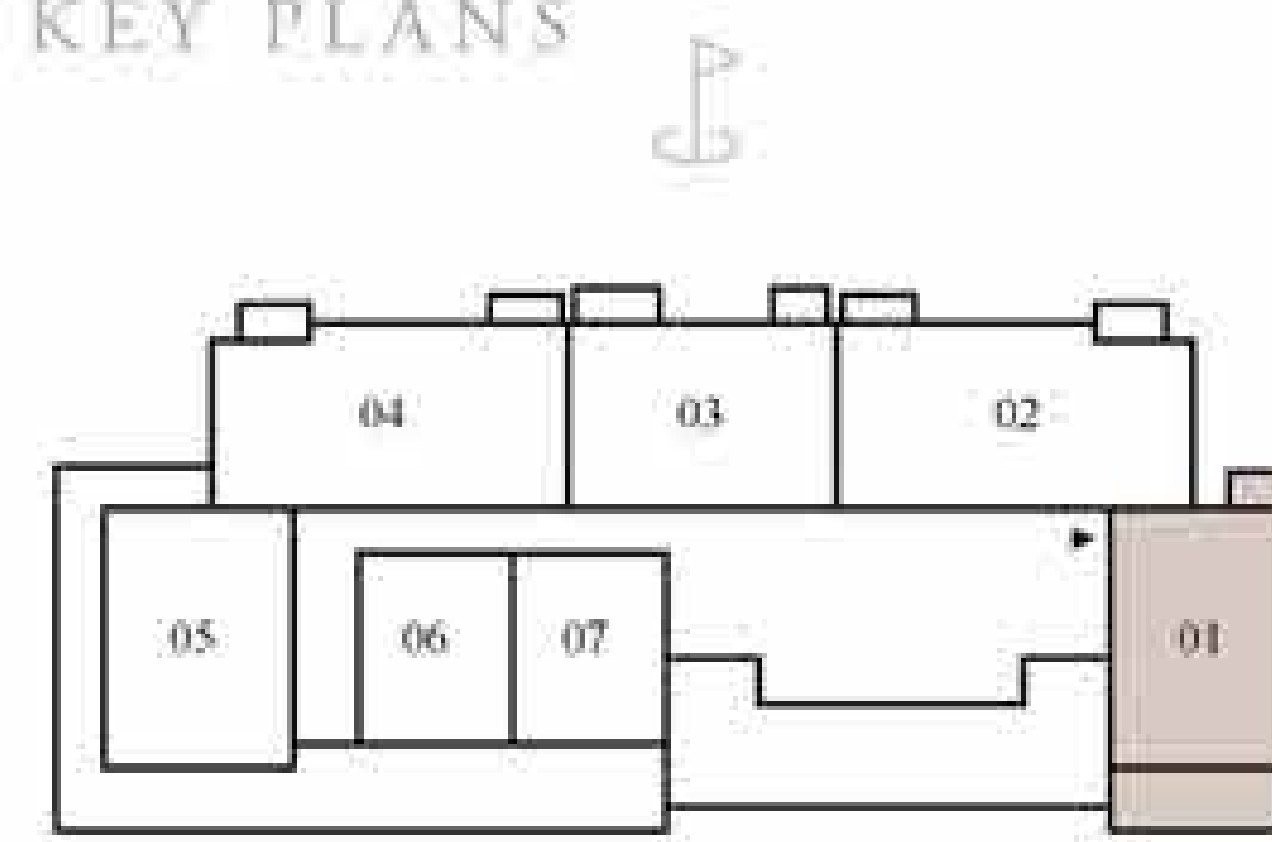

LEVEL 1

FLOOR PLAN 1. All dimensions are in imperial and metric, and measured from finish to finish excluding construction tolerances. 2. All materials, dimensions, and drawings are approximate only. 3. Information is subject to change without notice, at developer's absolute discretion. 4. Actual area may vary from the stated area. 5. Drawings not to scale. 6. All images used are for illustrative purposes only and do not represent the actual size, features, specifications, fittings, and furnishings. 7. The developer reserves the right to make revisions / alterations, at it's absolute discretion, without any liability whatsoever.



# GOLF HILLSIDE

DUBAI HILLS ESTATE

## 2 BEDROOM TYPE A2

UNITS  
105

SUITE AREA	1092 SQ.FT.	101.45 SQ.M.
BALCONY AREA	787.70 SQ.FT.	73.18 SQ.M.
TOTAL AREA	1879.70 SQ.FT.	174.63 SQ.M.



### KEY SECTION



### KEY PLANS

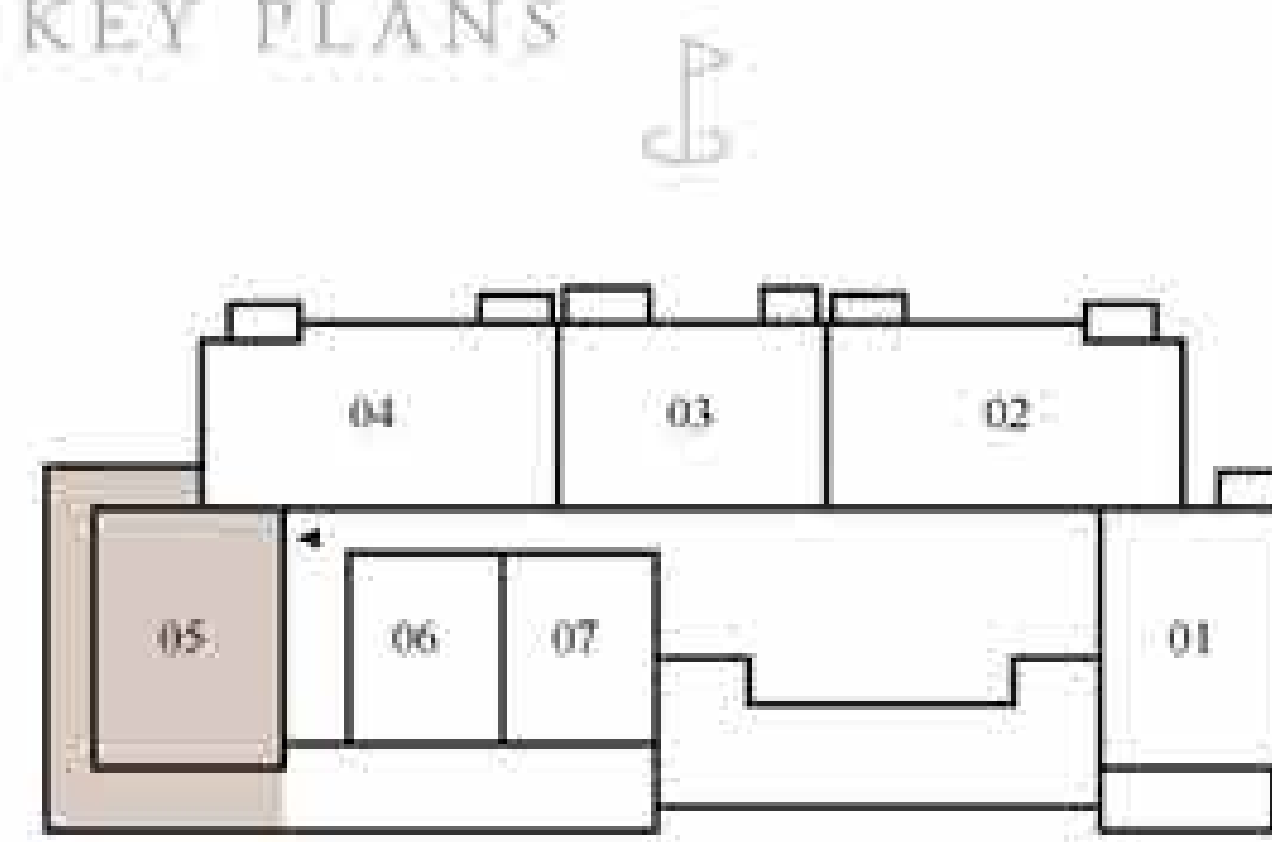

LEVEL 1

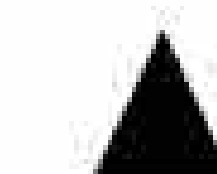

FLOOR PLAN 1. All dimensions are in imperial and metric, and measured from finish to finish excluding construction tolerances. 2. All materials, dimensions, and drawings are approximate only. 3. Information is subject to change without notice, at developer's absolute discretion. 4. Actual area may vary from the stated area. 5. Drawings not to scale. 6. All images used are for illustrative purposes only and do not represent the actual size, features, specifications, fittings, and furnishings. 7. The developer reserves the right to make revisions / alterations, at it's absolute discretion, without any liability whatsoever.

# GOLF HILLSIDE

DUBAI HILLS ESTATE

## 2 BEDROOM TYPE A3

### UNITS

202, 302, 402, 502, 602, 702, 802, 902, 1002,  
1102, 1202, 1302, 1402, 1502, 1602, 1702, 1802  
1902, 2002

SUITE AREA	1095.01 SQ.FT.	101.73 SQ.M.
BALCONY AREA	97.95 SQ.FT.	9.10 SQ.M.
TOTAL AREA	1192.96 SQ.FT.	110.83 SQ.M.



### KEY SECTION

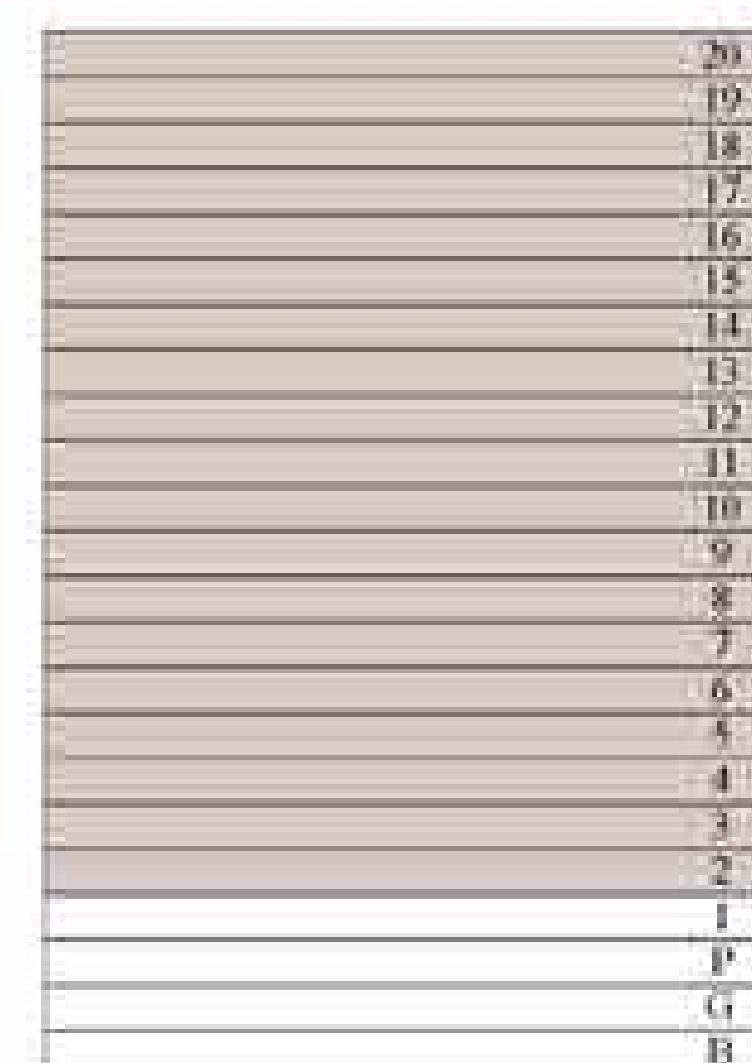

### KEY PLANS

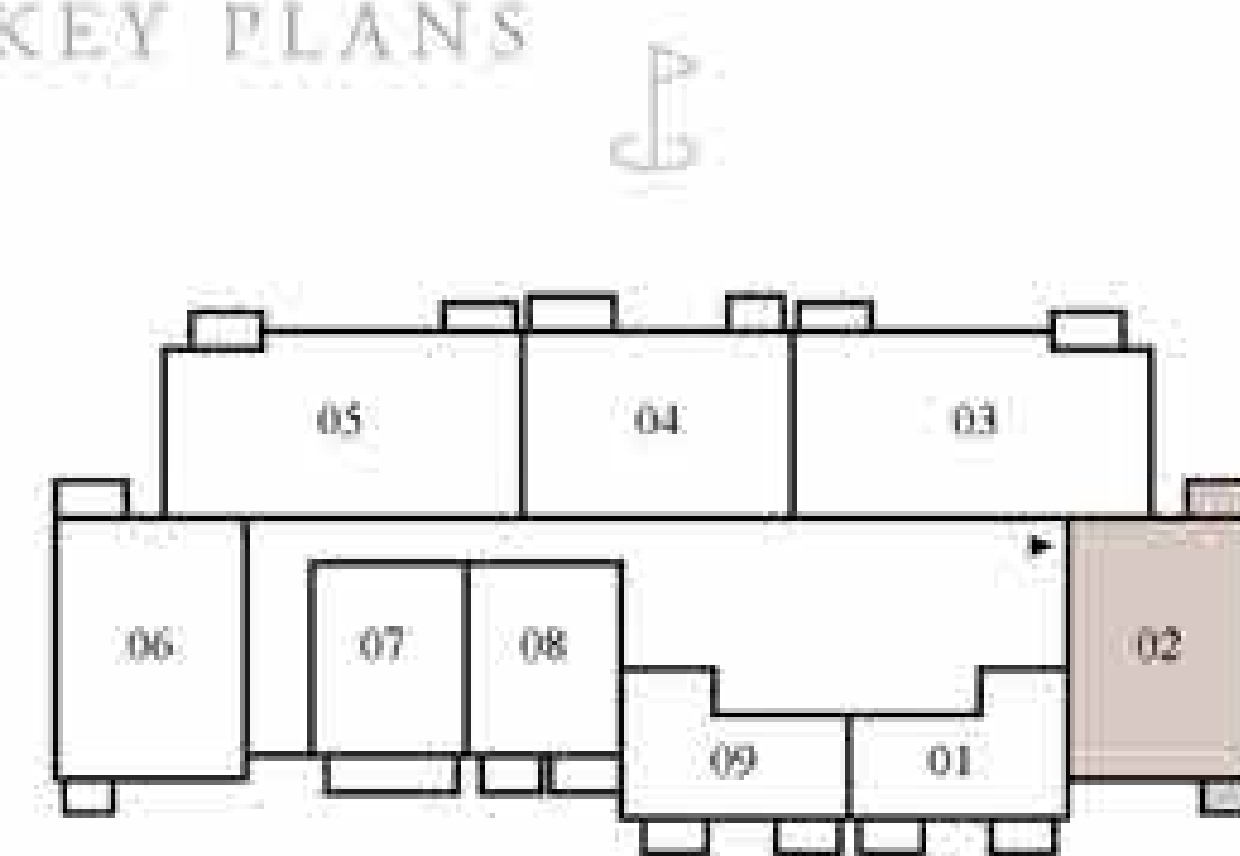

LEVEL 2 TO 20

FLOOR PLAN 1. All dimensions are in imperial and metric, and measured from finish to finish excluding construction tolerances. 2. All materials, dimensions, and drawings are approximate only. 3. Information is subject to change without notice, at developer's absolute discretion. 4. Actual area may vary from the stated area. 5. Drawings not to scale. 6. All images used are for illustrative purposes only and do not represent the actual size, features, specifications, fittings, and furnishings. 7. The developer reserves the right to make revisions / alterations, at its absolute discretion, without any liability whatsoever.

# GOLF HILLSIDE

DUBAI HILLS ESTATE

## 2 BEDROOM TYPE A4

### UNITS

206, 306, 406, 506, 606, 706, 806, 906, 1006,  
1106, 1206, 1306, 1406, 1506, 1606, 1706, 1806,  
1906, 2006

SUITE AREA	1092 SQ.FT.	101.45 SQ.M.
BALCONY AREA	97.95 SQ.FT.	9.10 SQ.M.
TOTAL AREA	1189.95 SQ.FT.	110.55 SQ.M.



### KEY SECTION

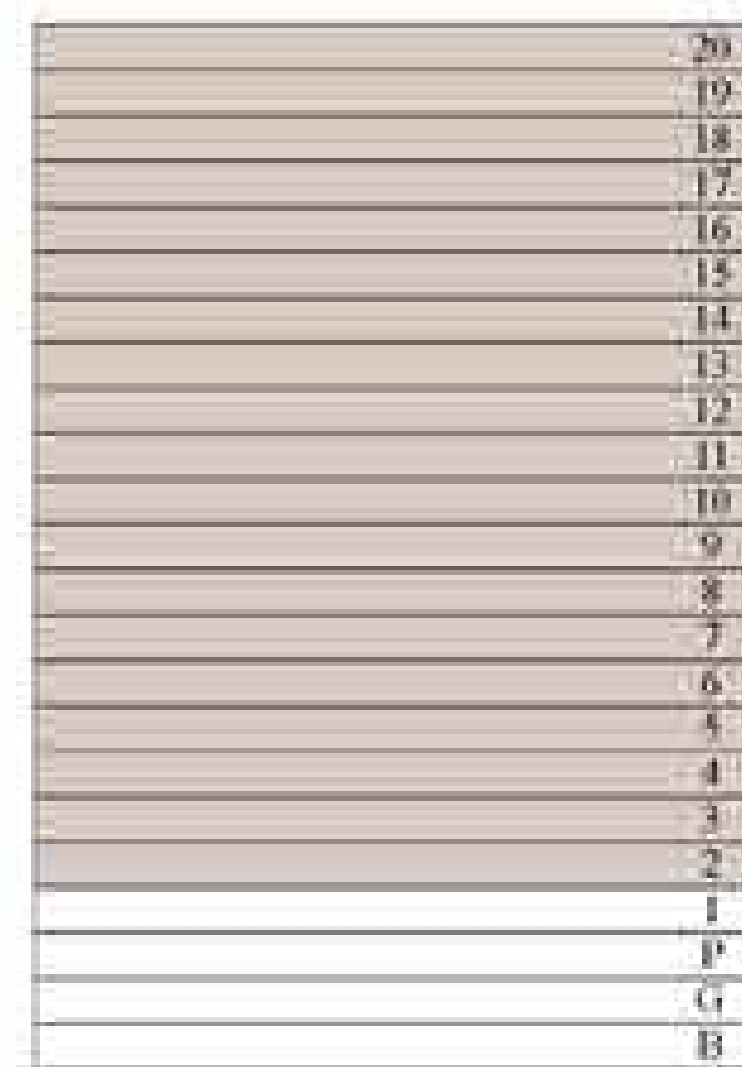

### KEY PLANS

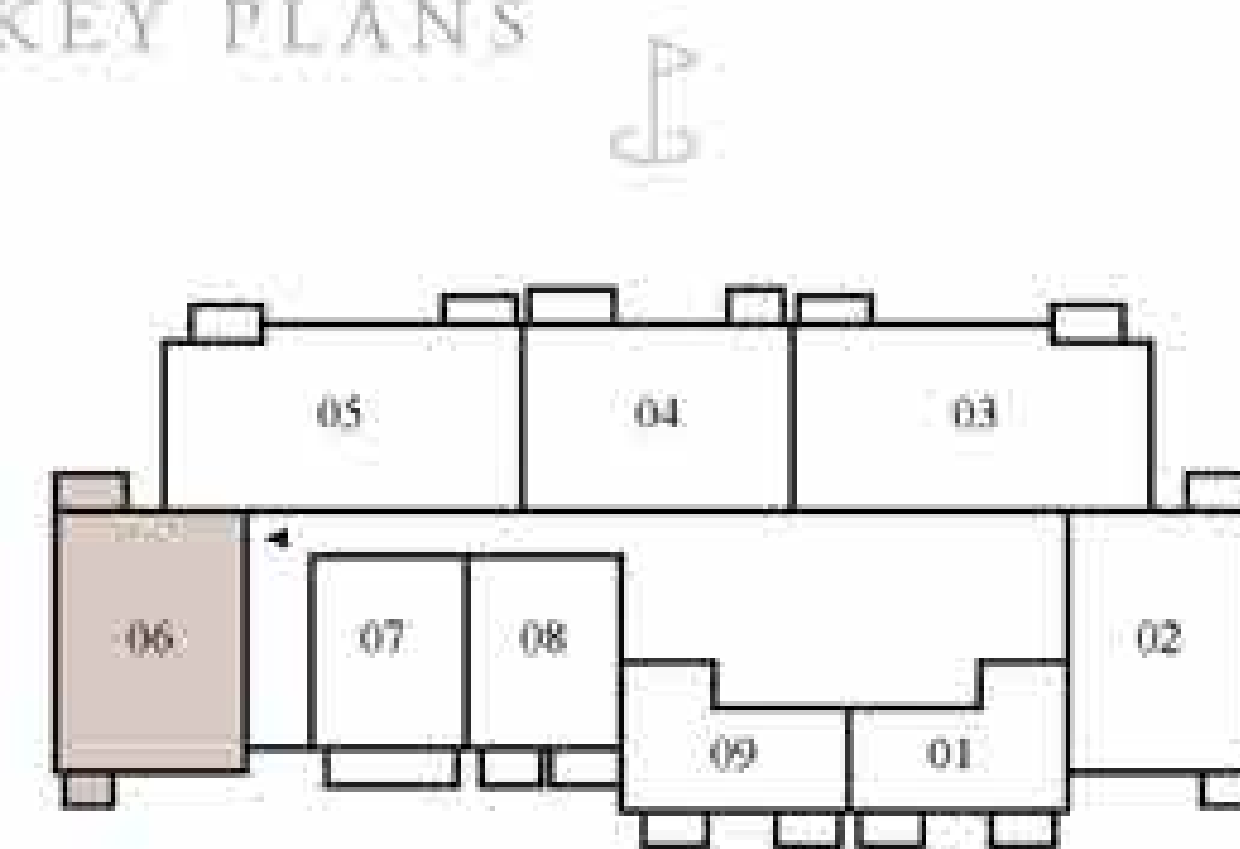

LEVEL 2 TO 20



FLOOR PLAN 1. All dimensions are in imperial and metric, and measured from finish to finish excluding construction tolerances. 2. All materials, dimensions, and drawings are approximate only. 3. Information is subject to change without notice, at developer's absolute discretion. 4. Actual area may vary from the stated area. 5. Drawings not to scale. 6. All images used are for illustrative purposes only and do not represent the actual size, features, specifications, fittings, and furnishings. 7. The developer reserves the right to make revisions / alterations, at it's absolute discretion, without any liability whatsoever.

# GOLF HILLSIDE

DUBAI HILLS ESTATE

## 2 BEDROOM TYPE B1

UNITS  
G02

SUITE AREA	1101.15 SQ.FT.	102.30 SQ.M.
BALCONY AREA	474.90 SQ.FT.	44.12 SQ.M.
TOTAL AREA	1576.05 SQ.FT.	146.42 SQ.M.

### KEY SECTION

20
19
18
17
16
15
14
13
12
11
10
9
8
7
6
5
4
3
2
1
P
G
B

### KEY PLANS

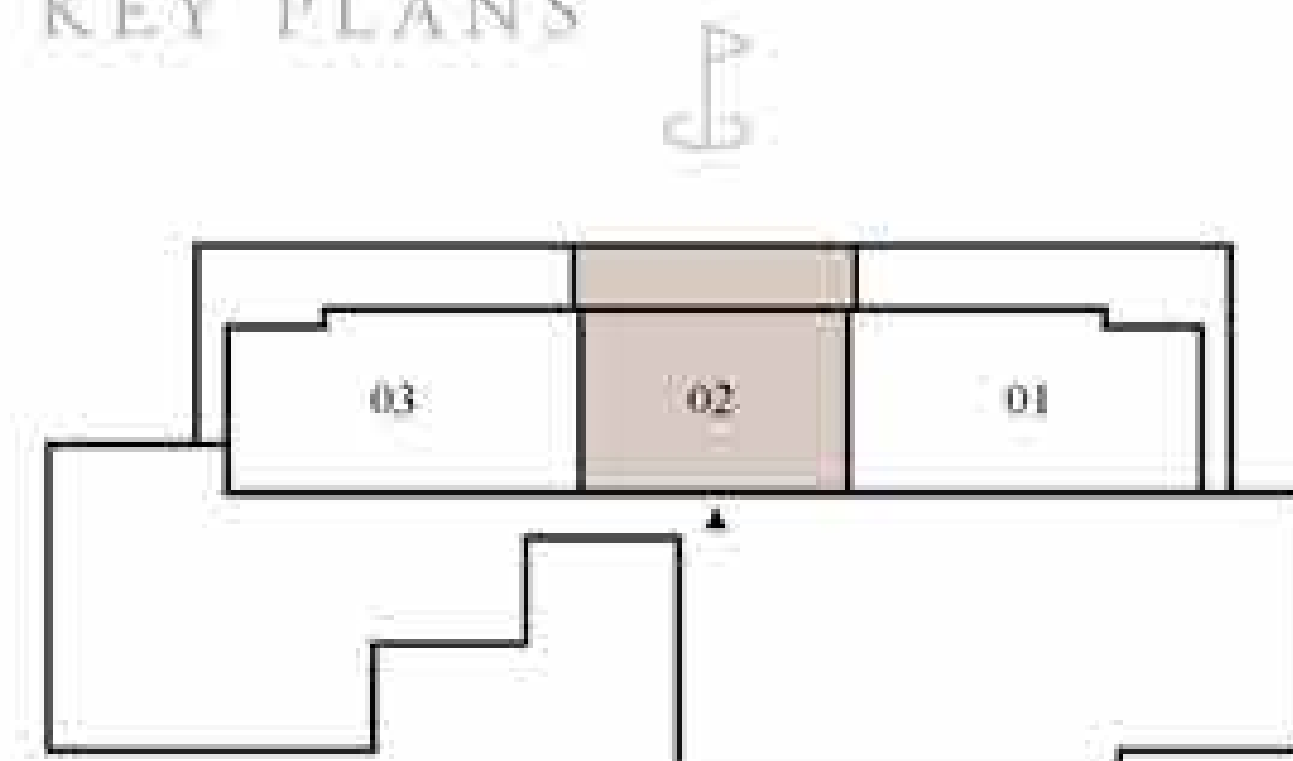

GROUND



FLOOR PLAN 1. All dimensions are in imperial and metric, and measured from finish to finish excluding construction tolerances. 2. All materials, dimensions, and drawings are approximate only. 3. Information is subject to change without notice, at developer's absolute discretion. 4. Actual area may vary from the stated area. 5. Drawings not to scale. 6. All images used are for illustrative purposes only and do not represent the actual size, features, specifications, fittings, and furnishings. 7. The developer reserves the right to make revisions / alterations, at it's absolute discretion, without any liability whatsoever.



EMAAR

# GOLF HILLSIDE

DUBAI HILLS ESTATE

## 2 BEDROOM TYPE B2

### UNITS

P02, 103, 204, 304, 404, 504, 604, 704, 804,  
904, 1004, 1104, 1204, 1304, 1404, 1504, 1604  
1704, 1804, 1904, 2004

SUITE AREA	1101.15 SQ.FT.	102.30 SQ.M.
BALCONY AREA	120.56 SQ.FT.	11.20 SQ.M.
TOTAL AREA	1221.70 SQ.FT.	113.50 SQ.M.



### KEY SECTION

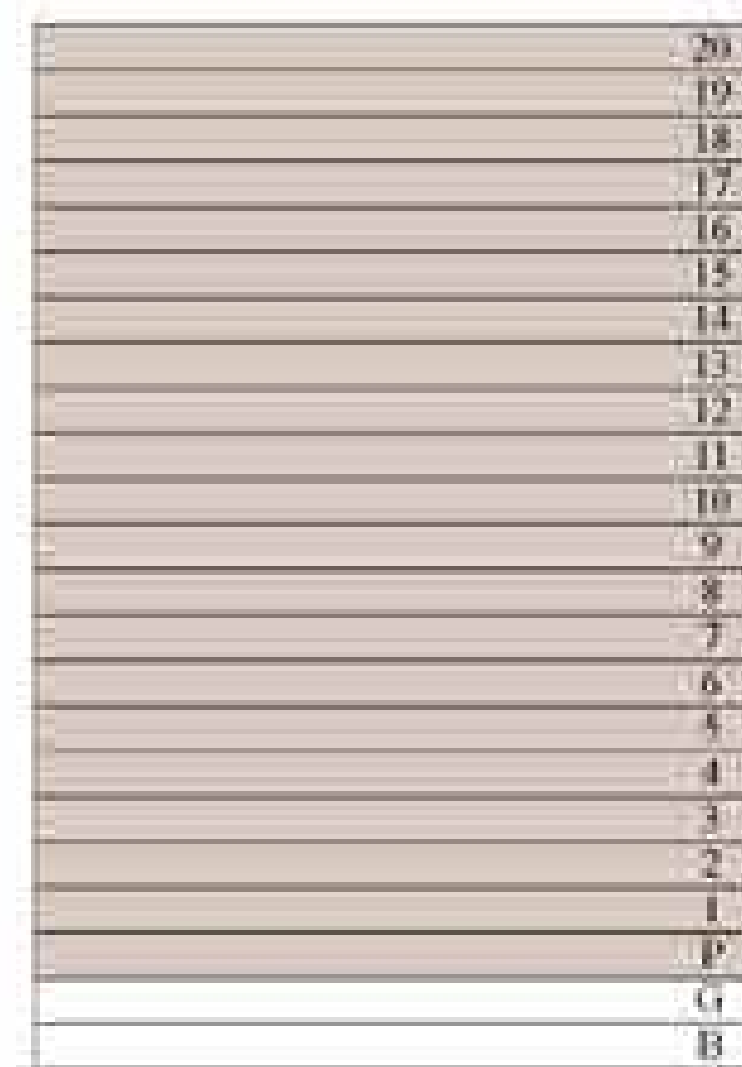

### KEY PLANS

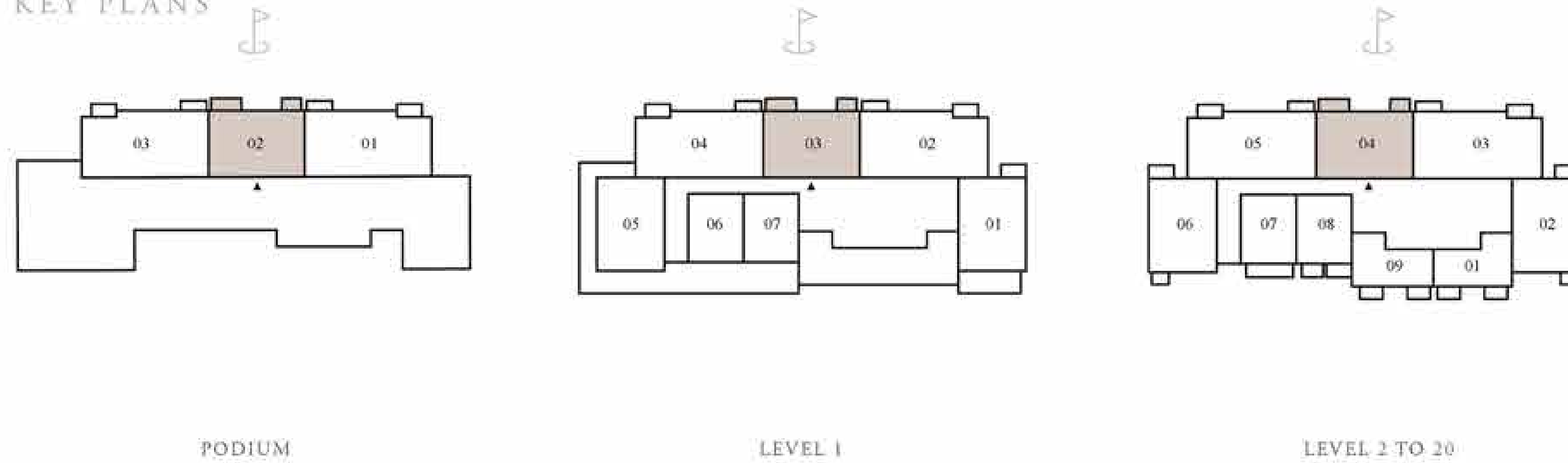

FLOOR PLAN 1. All dimensions are in imperial and metric, and measured from finish to finish excluding construction tolerances. 2. All materials, dimensions, and drawings are approximate only. 3. Information is subject to change without notice, at developer's absolute discretion. 4. Actual area may vary from the stated area. 5. Drawings not to scale. 6. All images used are for illustrative purposes only and do not represent the actual size, features, specifications, fittings, and furnishings. 7. The developer reserves the right to make revisions / alterations, at it's absolute discretion, without any liability whatsoever.



EMAAR

# GOLF HILLSIDE

DUBAI HILLS ESTATE

## 3 BEDROOM TYPE A1

UNITS  
G03

SUITE AREA	1498.23 SQ.FT.	139.19 SQ.M.
BALCONY AREA	787.81 SQ.FT.	73.19 SQ.M.
TOTAL AREA	2286.04 SQ.FT.	212.38 SQ.M.



### KEY SECTION



### KEY PLANS

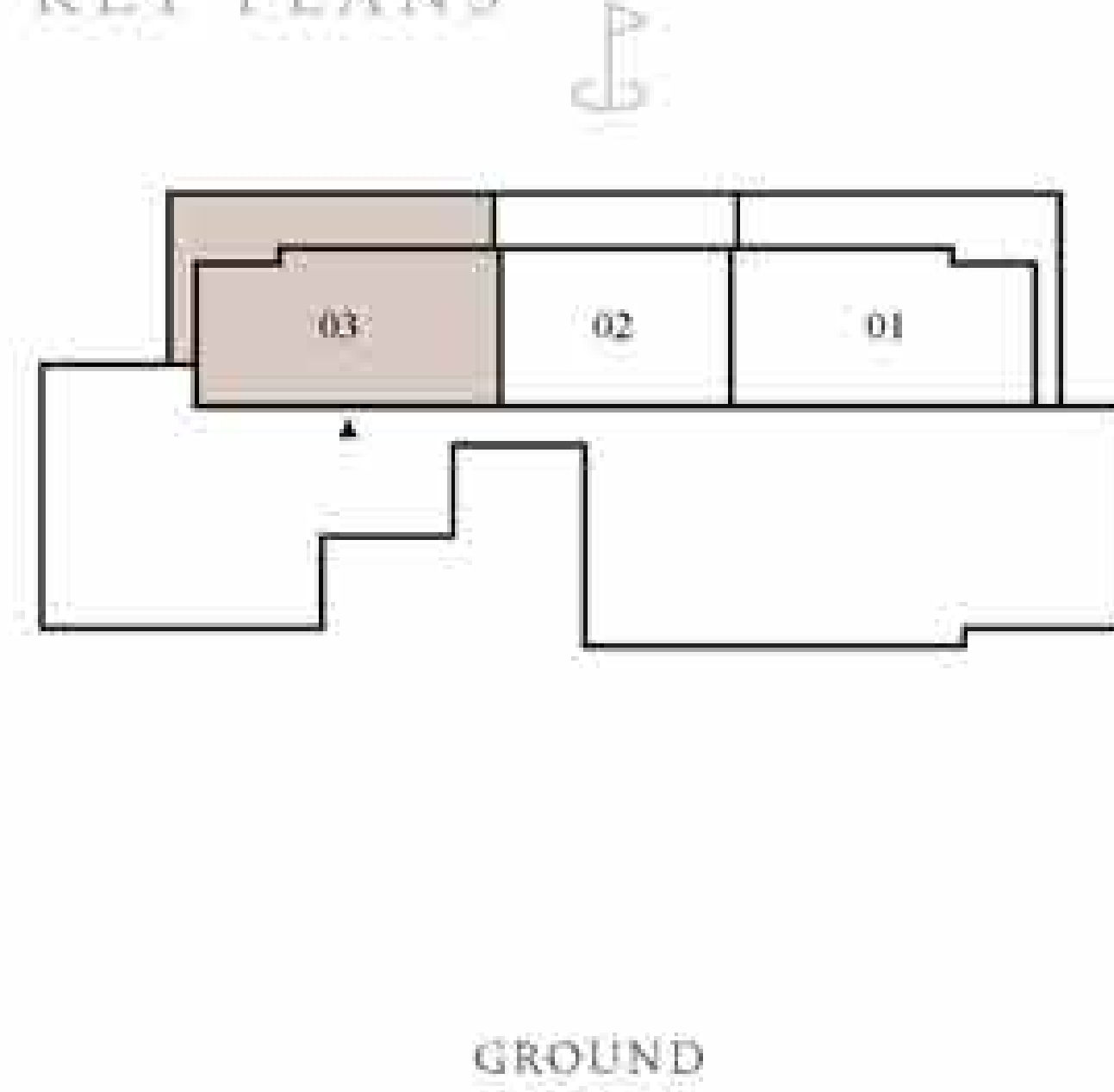

FLOOR PLAN 1. All dimensions are in imperial and metric, and measured from finish to finish excluding construction tolerances. 2. All materials, dimensions, and drawings are approximate only. 3. Information is subject to change without notice, at developer's absolute discretion. 4. Actual area may vary from the stated area. 5. Drawings not to scale. 6. All images used are for illustrative purposes only and do not represent the actual size, features, specifications, fittings, and furnishings. 7. The developer reserves the right to make revisions / alterations, at it's absolute discretion, without any liability whatsoever.



EMAAR

# GOLF HILLSIDE

DUBAI HILLS ESTATE

## 3 BEDROOM TYPE A2

UNITS  
G01

SUITE AREA	1498.12 SQ.FT.	139.18 SQ.M
BALCONY AREA	824.08 SQ.FT.	76.56 SQ.M
TOTAL AREA	2322.21 SQ.FT.	215.74 SQ.M



### KEY SECTION



### KEY PLANS

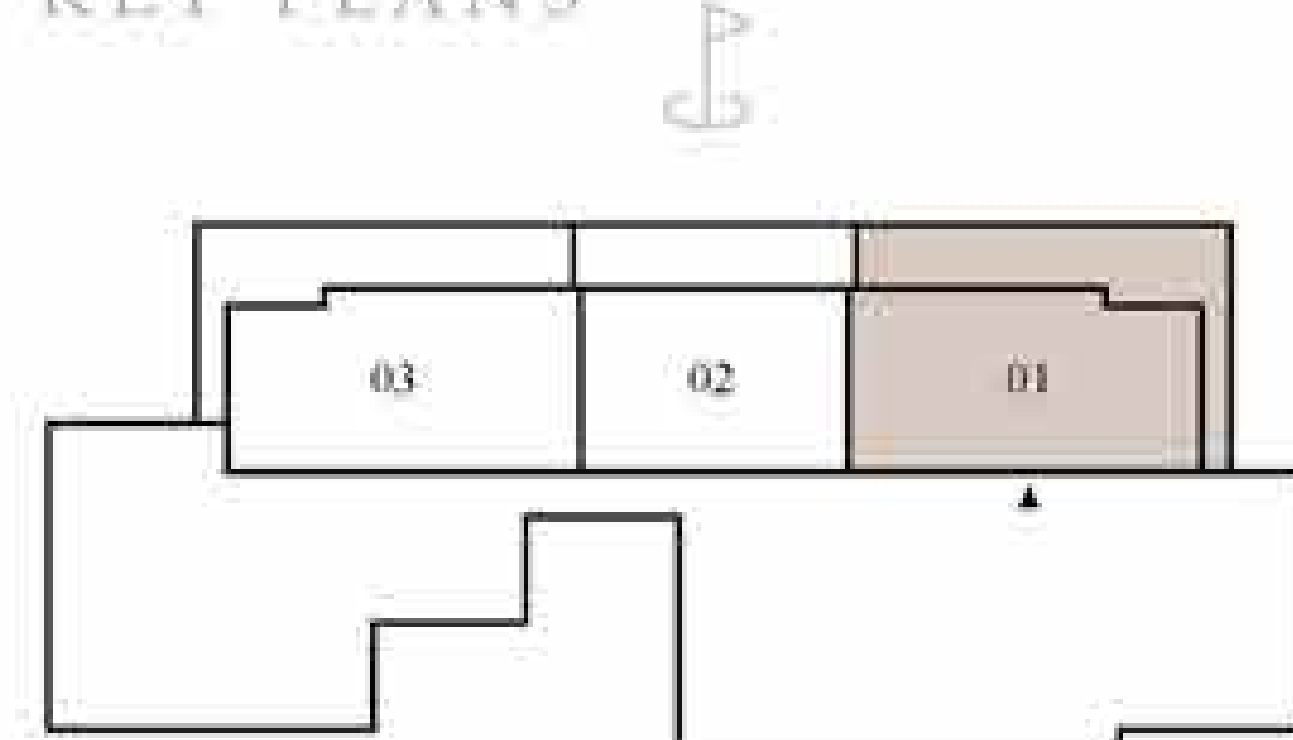

GROUND

FLOOR PLAN 1. All dimensions are in imperial and metric, and measured from finish to finish excluding construction tolerances. 2. All materials, dimensions, and drawings are approximate only. 3. Information is subject to change without notice, at developer's absolute discretion. 4. Actual area may vary from the stated area. 5. Drawings not to scale. 6. All images used are for illustrative purposes only and do not represent the actual size, features, specifications, fittings, and furnishings. 7. The developer reserves the right to make revisions / alterations, at it's absolute discretion, without any liability whatsoever.



EMAAR

# GOLF HILLSIDE

DUBAI HILLS ESTATE

## 3 BEDROOM TYPE A3

### UNITS

P03, 104, 205, 305, 405, 505, 605, 705, 805,  
905, 1005, 1105, 1205, 1305, 1405, 1505, 1605  
1705, 1805, 1905, 2005

SUITE AREA	1498.34 SQ.FT.	139.20 SQ.M.
BALCONY AREA	104.95 SQ.FT.	9.75 SQ.M.
TOTAL AREA	1603.28 SQ.FT.	148.95 SQ.M.



### KEY SECTION

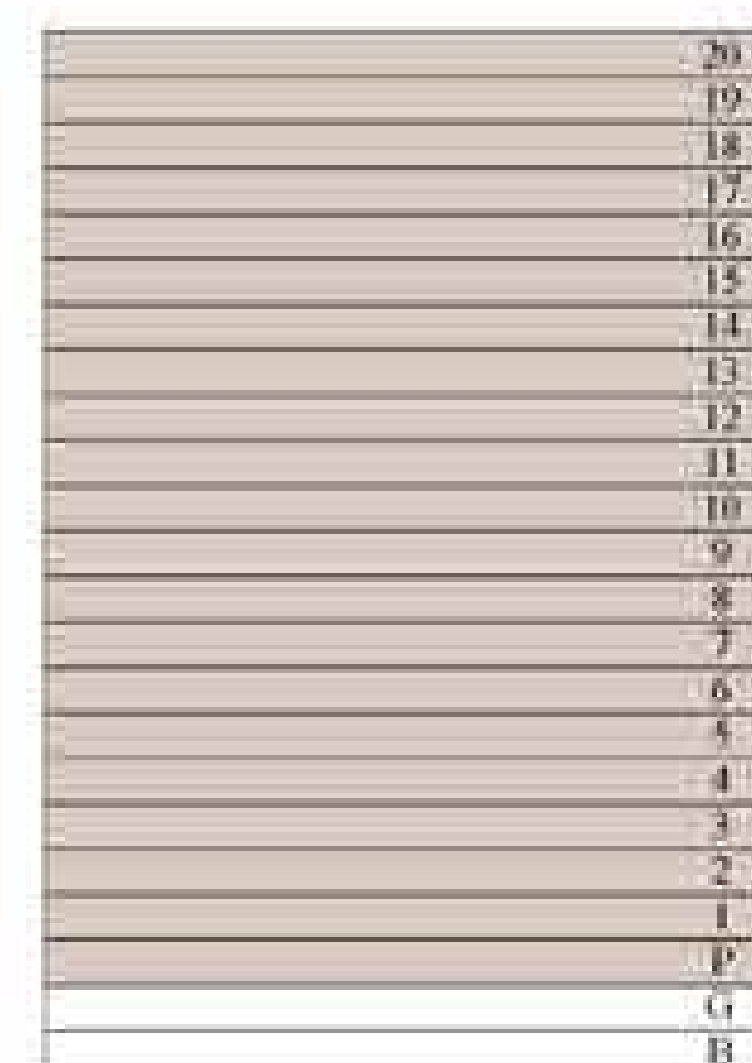

### KEY PLANS

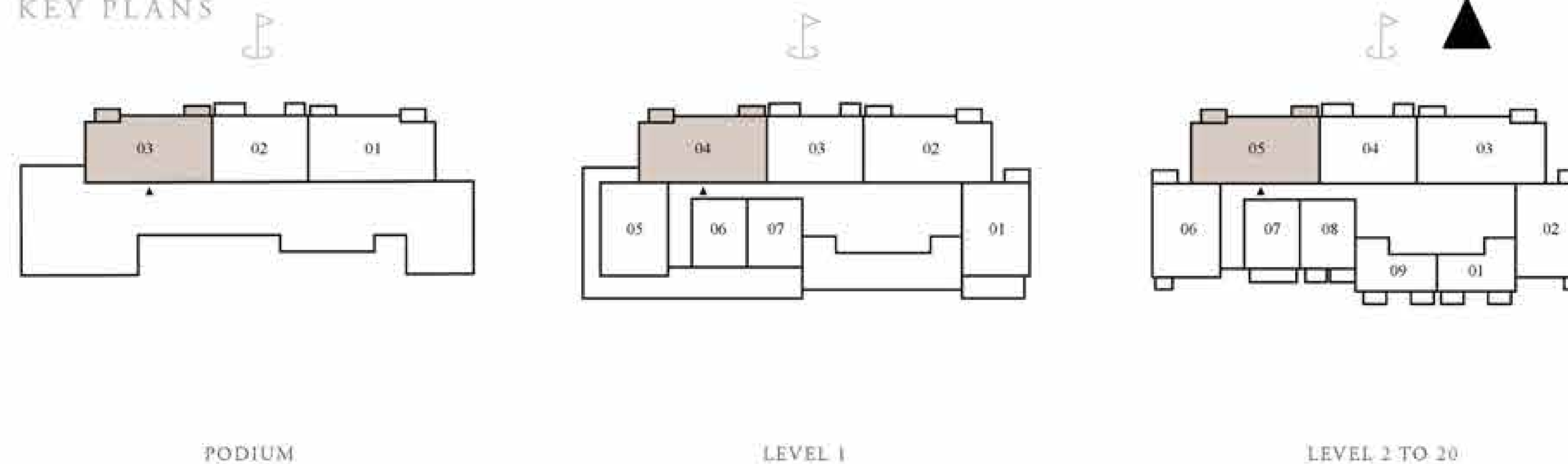

FLOOR PLAN 1. All dimensions are in imperial and metric, and measured from finish to finish excluding construction tolerances. 2. All materials, dimensions, and drawings are approximate only. 3. Information is subject to change without notice, at developer's absolute discretion. 4. Actual area may vary from the stated area. 5. Drawings not to scale. 6. All images used are for illustrative purposes only and do not represent the actual size, features, specifications, fittings, and furnishings. 7. The developer reserves the right to make revisions / alterations, at it's absolute discretion, without any liability whatsoever.



# GOLF HILLSIDE

DUBAI HILLS ESTATE

## 3 BEDROOM TYPE A4

### UNITS

P01, 102, 203, 303, 403, 503, 603, 703, 803, 903, 1003, 1103, 1203, 1303, 1403, 1503, 1603, 1703, 1803, 1903, 2003

SUITE AREA	1498.01-1498.23 SQ.FT.	139.17-139.19 SQ.M.
BALCONY AREA	104.95 SQ.FT.	9.75 SQ.M.
TOTAL AREA	1602.96-1603.18 SQ.FT.	148.92-148.94 SQ.M.



### KEY SECTION

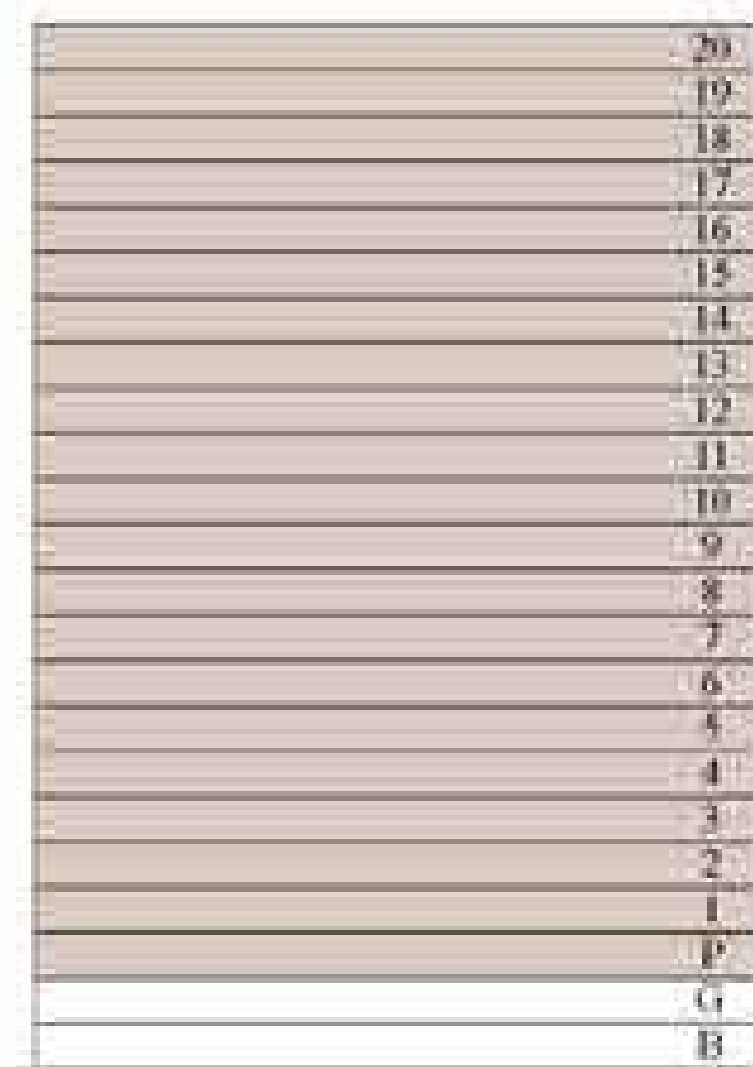

### KEY PLANS

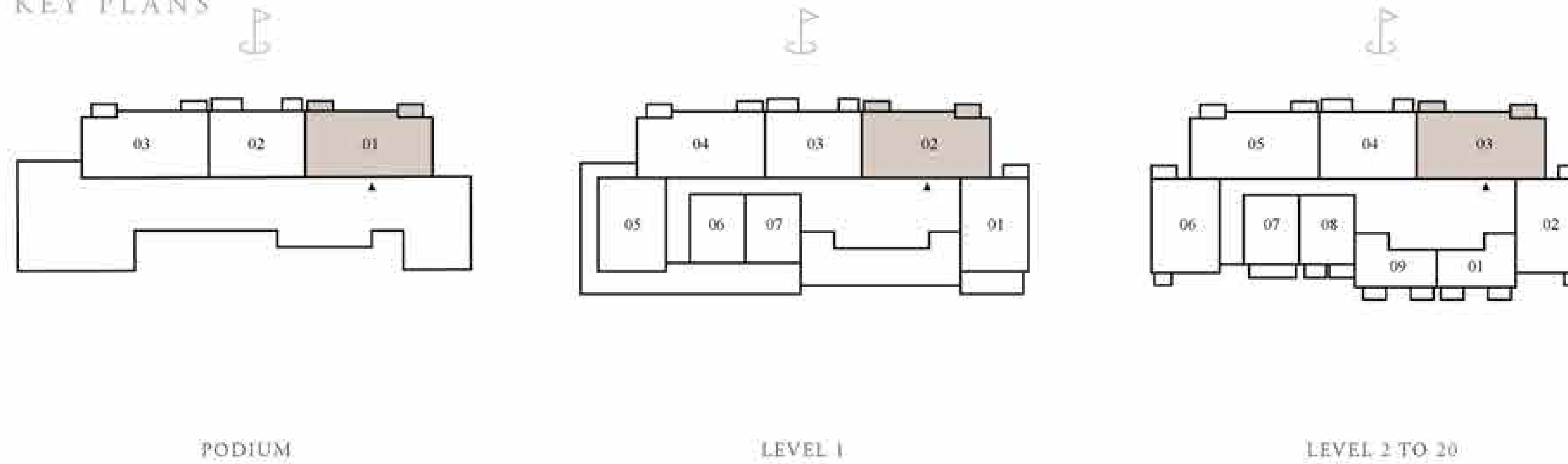

FLOOR PLAN 1. All dimensions are in imperial and metric, and measured from finish to finish excluding construction tolerances. 2. All materials, dimensions, and drawings are approximate only. 3. Information is subject to change without notice, at developer's absolute discretion. 4. Actual area may vary from the stated area. 5. Drawings not to scale. 6. All images used are for illustrative purposes only and do not represent the actual size, features, specifications, fittings, and furnishings. 7. The developer reserves the right to make revisions / alterations, at it's absolute discretion, without any liability whatsoever.



BUY | SELL | RENT | PROPERTY MANAGEMENT SERVICES

## GET IN TOUCH WITH US

 **+971 56 818 8610**

 **info@homes4life.ae**

 **Head Office:**  
Office 25 | Oasis Center | Sheikh Zayed Road | Dubai | +971 4 338 7300

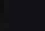
 **Branch Office:**  
Retail 1 | Safi Apartments | Town Square Dubai | Dubai | +971 4 398 1528