

A photograph of a modern villa at dusk. The scene features a swimming pool in the foreground, a lounge area with a wooden bench and cushions, and a large glass-walled interior where a couple is sitting. The sky is dark blue, and palm trees are visible in the background. A dark purple diagonal shape is overlaid on the left side of the image, containing the text.

**TYPICAL  
TOWNHOUSES  
& VILLAS**

*4-PLEX CLUSTER TYPE 1 - STANDARD (FRONT)*



*4-PLEX CLUSTER **TYPE 1** - STANDARD (BACK)*



*4-PLEX CLUSTER TYPE 2 - STANDARD (FRONT)*



*4-PLEX CLUSTER TYPE 2 - STANDARD (BACK)*



# 3-BED TOWNHOUSE

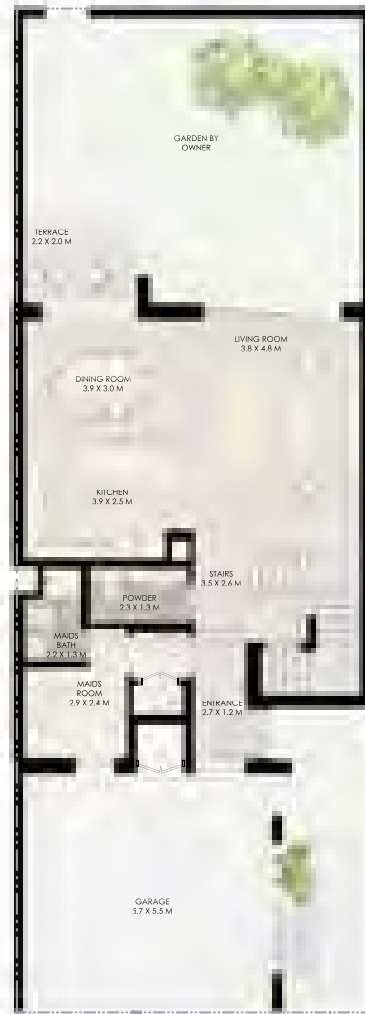

# 4-BED TOWNHOUSE



GROUND FLOOR PLAN

(NOTE: LANDSCAPE BY OWNER)



FIRST FLOOR PLAN

*3-BED VILLA **TYPE 1**- STANDARD (FRONT)*





*3-BED VILLA **TYPE 1**- STANDARD (BACK)*



*3-BED VILLA TYPE 2- STANDARD (FRONT)*



*3-BED VILLA **TYPE 2**- STANDARD (BACK)*



# 3-BED VILLA - STANDARD



GROUND FLOOR PLAN  
*(NOTE: LANDSCAPE BY OWNER)*



FIRST FLOOR PLAN

*4-BED VILLA **TYPE 1** - STANDARD (FRONT)*



*STREET VIEW*

4-BED VILLA **TYPE 1** - STANDARD (BACK)



4-BED VILLA **TYPE 2**- STANDARD (FRONT)



4-BED VILLA **TYPE 2**- STANDARD (BACK)





# 4-BED VILLA - STANDARD



GROUND FLOOR PLAN  
*(NOTE: LANDSCAPE BY OWNER)*



FIRST FLOOR PLAN

*5-BED VILLA TYPE 1 - STANDARD (FRONT)*



*5-BED VILLA TYPE 1 - STANDARD (BACK)*



5-BED VILLA **TYPE 2** - STANDARD (FRONT)



*5-BED VILLA **TYPE 2** - STANDARD (BACK)*



# 5-BED VILLA - STANDARD



GROUND FLOOR PLAN

(NOTE: LANDSCAPE BY OWNER)



FIRST FLOOR PLAN

A modern, two-story villa with large glass windows and a swimming pool. The villa is surrounded by lush greenery, including palm trees and other tropical plants. The scene is set during the day with a clear blue sky. A dark purple diagonal shape is overlaid on the left side of the image.

**PREMIUM VILLAS**

4-BED VILLA **HORIZON** - PREMIUM (FRONT)





4-BED VILLA **HORIZON** - PREMIUM (BACK)



4-BED VILLA **PILLAR** - PREMIUM (FRONT)



4-BED VILLA **PILLAR** - PREMIUM (BACK)



# 4-BED VILLA - PREMIUM



GROUND FLOOR PLAN  
 (NOTE: LANDSCAPE BY OWNER)



FIRST FLOOR PLAN

*5-BED VILLA **HORIZON** - PREMIUM (FRONT)*



5-BED VILLA **HORIZON** - PREMIUM (BACK)



5-BED VILLA **PILLAR** - PREMIUM (FRONT)



5-BED VILLA **PILLAR** - PREMIUM (BACK)







*6-BED VILLA HORIZON - PREMIUM (FRONT)*



6-BED VILLA **HORIZON** - PREMIUM (BACK)



*6-BED VILLA **PILLAR** - PREMIUM (FRONT)*



6-BED VILLA **PILLAR** - PREMIUM (BACK)





BUY | SELL | RENT | PROPERTY MANAGEMENT SERVICES

## GET IN TOUCH WITH US

 **+971 56 818 8610**

 **info@homes4life.ae**

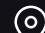
 **Head Office:**  
Office 25 | Oasis Center | Sheikh Zayed Road | Dubai | +971 4 338 7300

**Branch Office:**  
Retail 1 | Safi Apartments | Town Square Dubai | Dubai | +971 4 398 1528