

# CITY WALK

C R E S T L A N E



# A LEADING MASTER DEVELOPER

Meraas is the developer behind some of Dubai's most iconic addresses from Bluewaters Residences to BVLGARI Residences. Known for exclusive, limited-edition homes in exceptional locations, Meraas blends innovation with artistic mastery to create exceptional living environments. Each development has a signature setting where sophistication, serenity, and vibrant communities thrive.

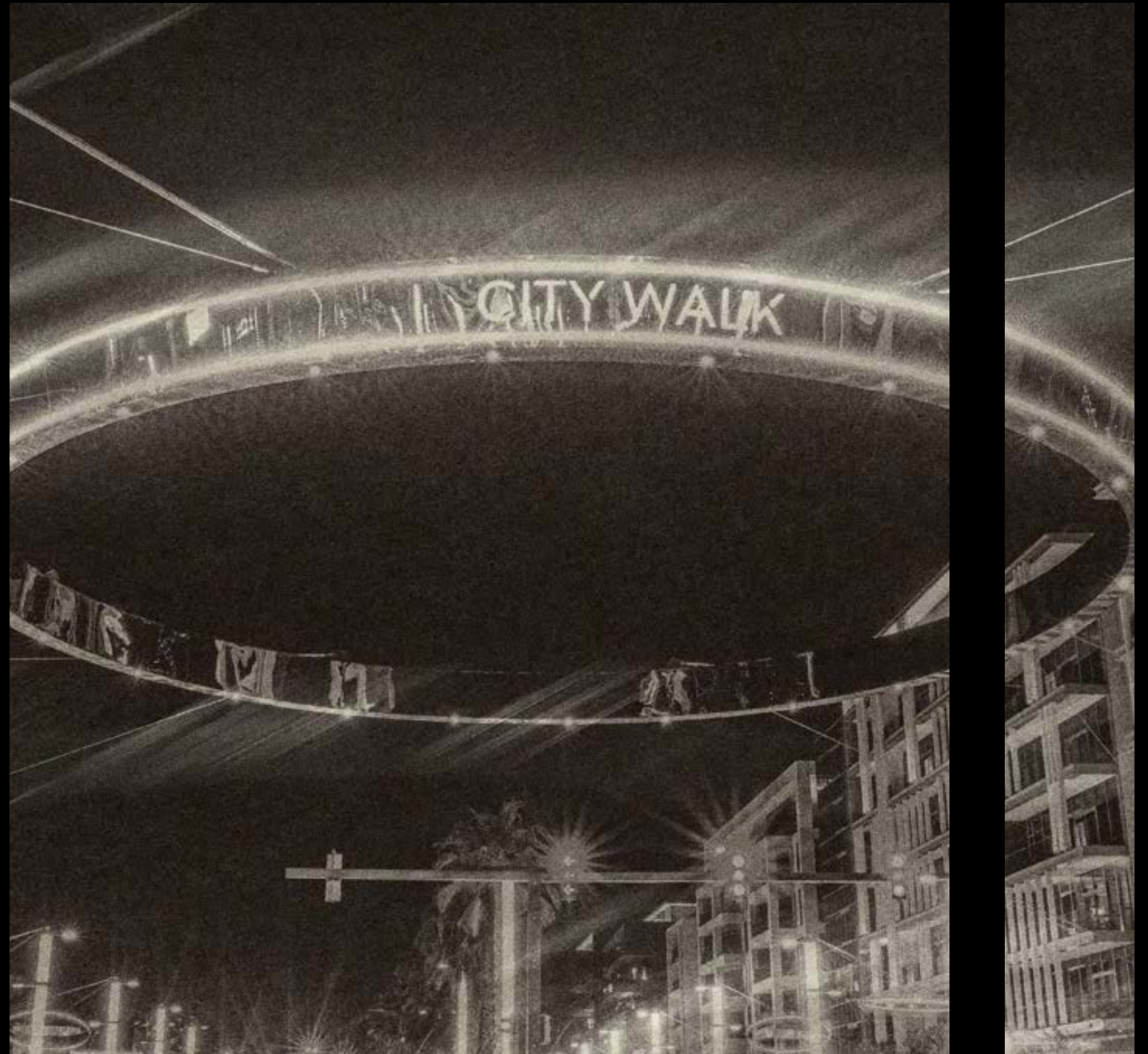



# CITY WALK

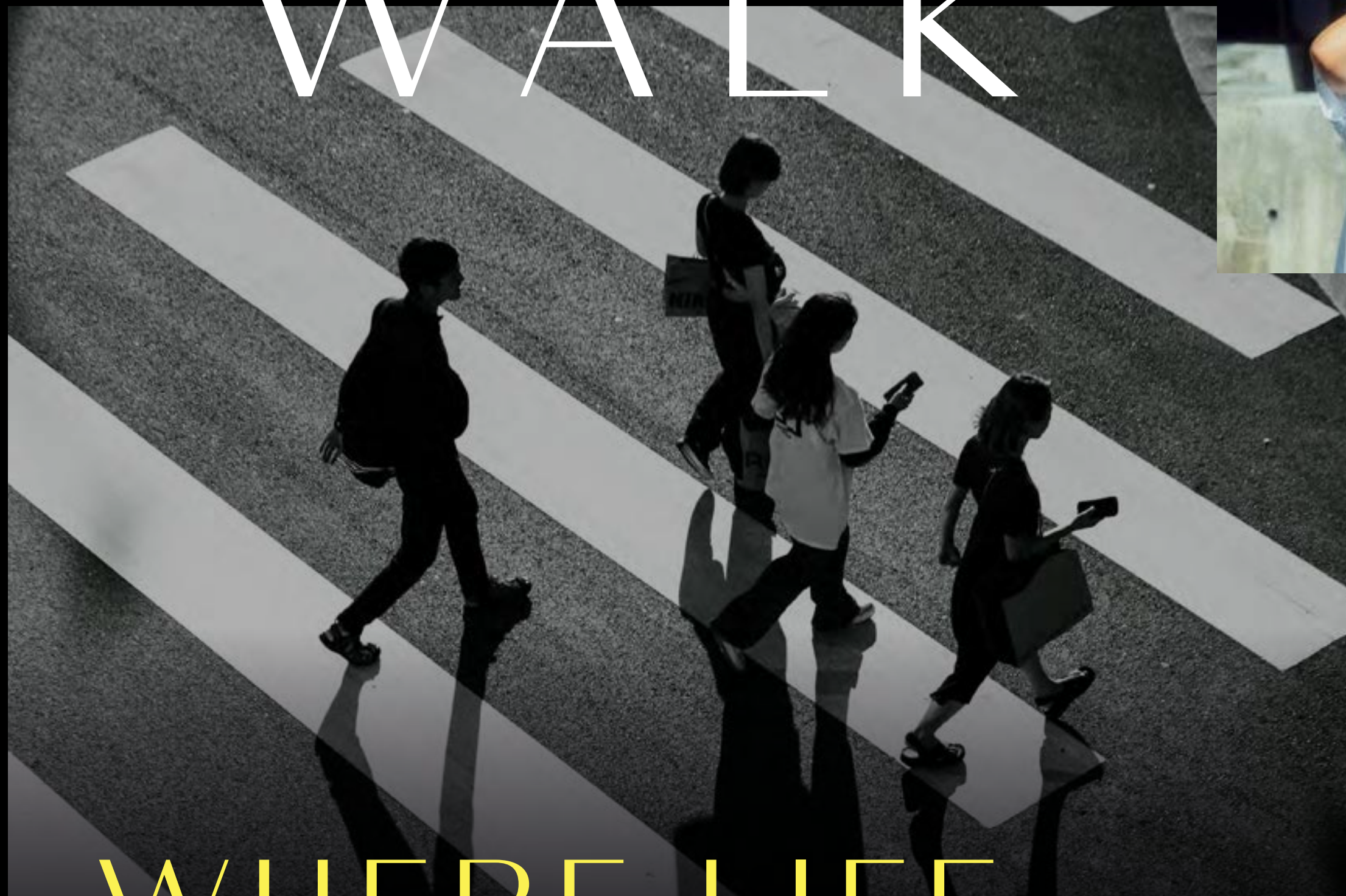

City Walk is a creative lifestyle space to live, work, and play in the heart of Dubai. This upscale destination boasts a fusion of international retail offerings, gourmet restaurants, luxurious residences, and hotels, blending cutting-edge design with modern conveniences.

Drawing inspiration from the vibrancy of urban living and easy connectivity, City Walk has evolved into one of the city's most distinguished and recognisable neighbourhoods.

## WHERE LIFE IS LIVED FULLY







# DIVE INTO

At City Walk Crestlane, every corner pulses with energy, and every moment invites you to embrace the beat of the city and the calm of waterside living, creating an experience as dynamic and unique as you are.

It's a new vibe. It's a new space. It's a new story.

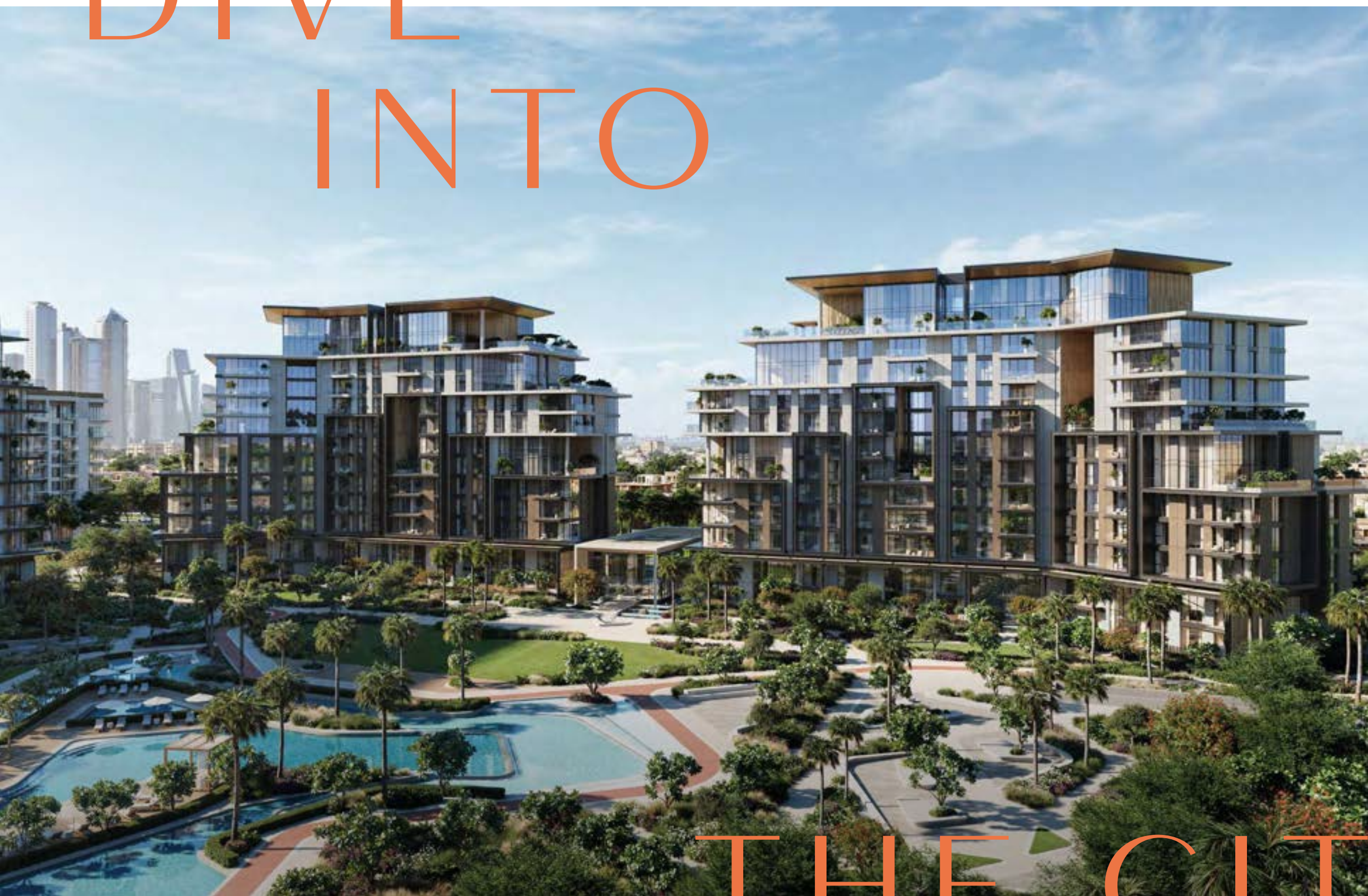

# THE CITY'S RHYTHM



# LET WATER SHAPE

Water isn't just a feature at City Walk Crestlane, it's the essence of this masterfully designed community. Every building faces the water, making it the first thing you see, and the last thing you think about.

From tranquil reflections to gentle ripples, water flows through every corner of the community, creating an atmosphere of movement and connection. Whether you're sitting back to enjoy the view, taking a refreshing dip, or gliding through its depths, here, the water draws you into its rhythm.



# THE CITY'S BEAT







# NEW BEATS MEET ICONIC STREETS

City Walk Crestlane offers seamless access to Dubai's most iconic landmarks and destinations. Just 10 minutes from the pristine shores of Jumeirah Beach and 5 minutes from the vibrant energy of Downtown Dubai, this prime location connects you to the city through major highways and road networks.

From breathtaking views of Dubai's glittering skyline to the tranquil expanse of the Arabian Gulf, this is a home where the best of both worlds meet. Here, city energy merges with peaceful, refreshing spaces, placing everything you love within reach, right in the heart of City Walk.

## CITY WALK CRESTLANE

2

MINUTES FROM  
CITY WALK MALL

3

MINUTES FROM  
SHEIKH ZAYED ROAD

7

MINUTES FROM  
JUMEIRAH BEACH

15

MINUTES FROM  
DXB AIRPORT

7

MINUTES FROM  
DUBAI MALL

11

MINUTES FROM  
DIFC



J1 BEACH

COCA-COLA  
ARENA



BURJ KHALIFA



BURJ AL ARAB

AL WASL ROAD

SHEIKH ZAYED ROAD

AL KHAIL ROAD



MEYDAN RACECOURSE



# VIBRANT AT EVERY TURN

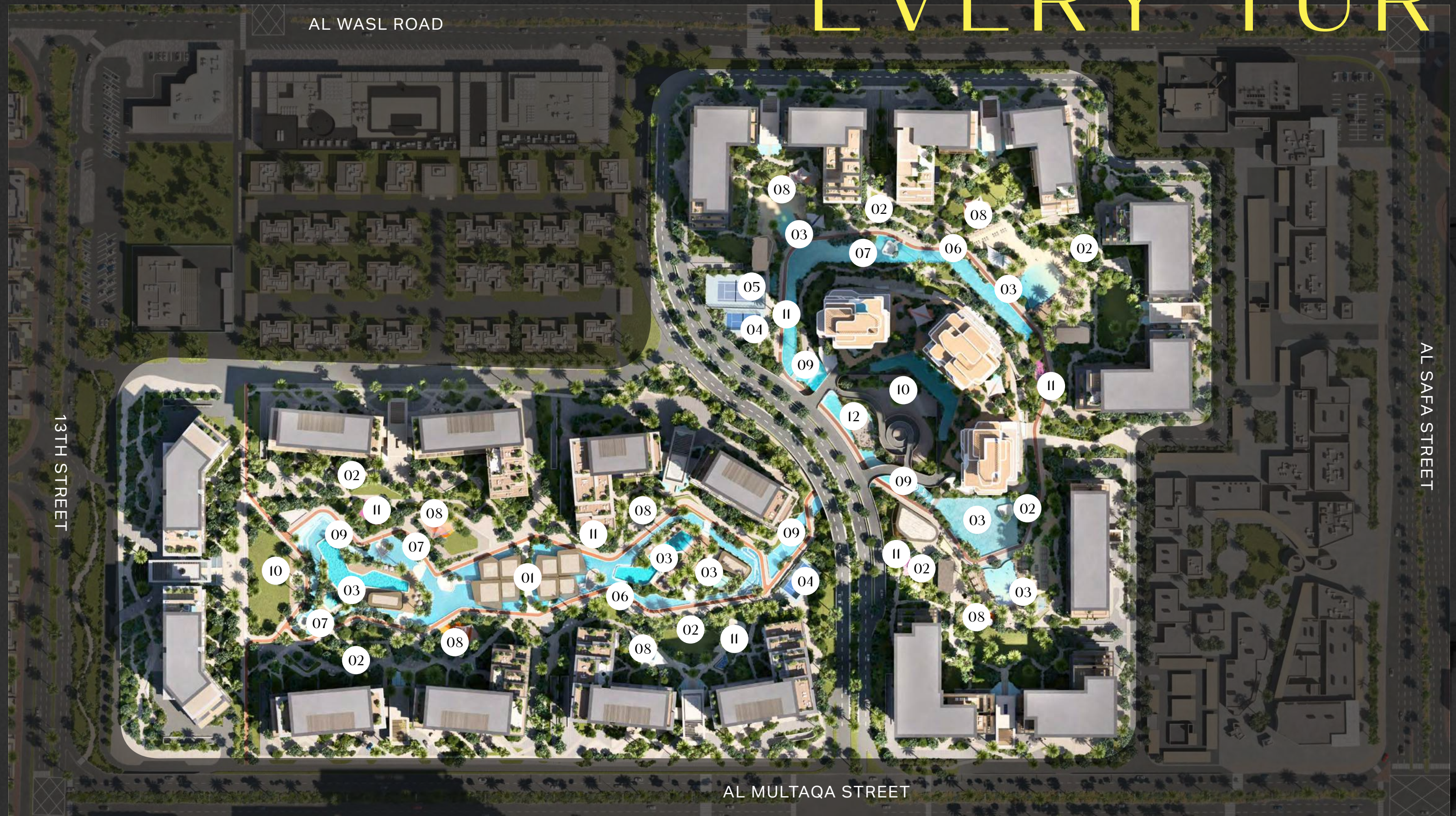

01 - COMMUNITY HUBS  
02 - YOGA AND EXERCISE LAWNS  
03 - SWIMMING POOLS  
04 - PADEL COURT

05 - TENNIS COURT  
06 - JOGGING TRACKS  
07 - SUNKEN SEATS  
08 - KIDS' PLAY AREA

09 - WATER FEATURES  
10 - EVENTS LAWN  
11 - OUTDOOR FITNESS STATIONS  
12 - OUTDOOR CINEMA







COMMUNITY

HUBS







# TRAINING STUDIO



The Cardio Space fuels high-energy workouts with cutting-edge equipment, all set against the serene water view. Meanwhile, the Weights Area is designed to push your limits, featuring the latest fitness tech in a space built for strength and power.



# YOGA STUDIO

The Yoga Studio is your calm within the storm—a serene escape where panoramic glass walls frame tranquil water views, inviting you to unwind, breathe, and find your balance in perfect harmony.





# COMMUNITY



The Community Lounge is a multipurpose space that effortlessly blends indoor and outdoor, featuring a sunken seating area overlooking the pool and waterscape.

Whether you're relaxing, socialising, or creating moments that matter, this is your space to make it happen, with views that inspire and vibes that energise.

# LOUNGE





The Collaborative Suite isn't just a workspace—it's the perfect fusion of productivity and peace, featuring modern workstations and expansive windows with uninterrupted water views to keep your creativity flowing and your vibe perfectly balanced.

This space also offers a library, providing a quiet retreat for reading when you need a break, making it the ideal environment to focus, collaborate, and create.

# COLLABORATIVE SUITE



# GAMES ROOM

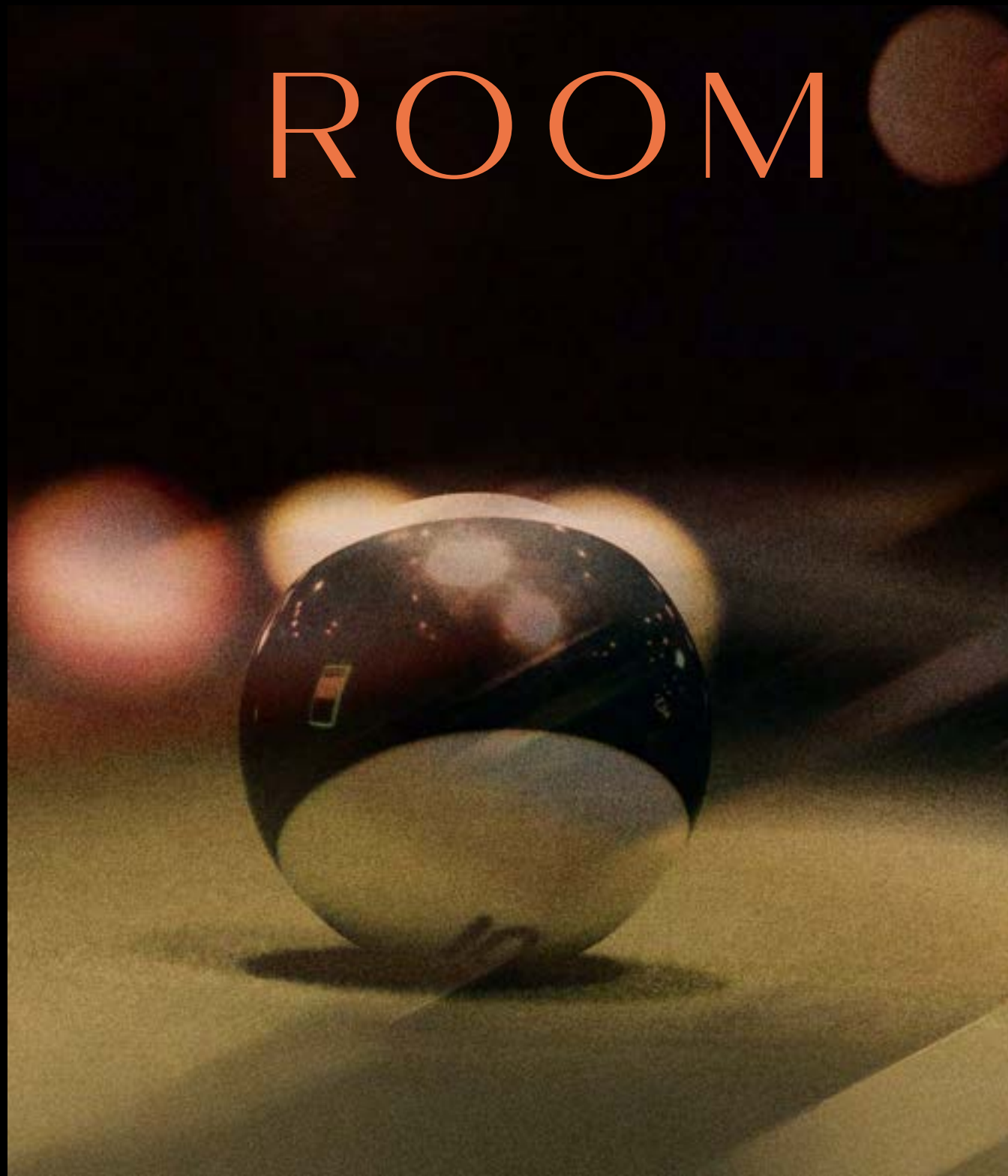

The Games Room is a sun-filled social space curated for connection and entertainment. With a selection of table games in a spacious and sophisticated setting, it offers the perfect backdrop to unwind, compete, and celebrate memorable moments.





OUTDOOR

EXPERIENCES







# SWIMMING POOLS



Dive into the refreshing waters, featuring infinity pools, beach-style pools, and dedicated kids' pools. Each space offers the perfect setting for residents to swim, relax, and enjoy quality time with family in a peaceful, resort-style atmosphere.





# WATER FEATURES

Embrace the community's ambiance,  
enhanced by stunning cascading water  
features that set a calming tone and invite  
relaxation and tranquillity throughout.





# SPORTS COURTS



Experience world-class Padel and Tennis Courts, where casual games meet intense competition, set in a vibrant, dynamic outdoor environment that pulses with energy.





Hit the winding jogging tracks that cut through lush greenery, offering the perfect route to run, walk, or just vibe with the outdoors. Dedicated cycling lanes curve with the terrain, giving both fitness enthusiasts and casual riders a chance to enjoy the community's vibrant, natural energy.

# ACTIVE TRACKS





# SUNKEN



# LOUNGES

Immerse yourself in the serenity of sunken seating nestled in water, offering a peaceful retreat amidst lush surroundings.





# EVENT LAWNS



Set the stage on the Event Lawns for unforgettable gatherings, from community events to exclusive celebrations, where the energy comes alive.



# OUTDOOR THEATRE

CINEMA



Experience movies like never before, with a stunning waterside backdrop that takes every screening to the next level.



# PLAY AREAS



Discover an engaging corner where children can explore, play, and learn with interactive equipment and creative play zones.



A NEW  
PULSE

IN THE  
CITY



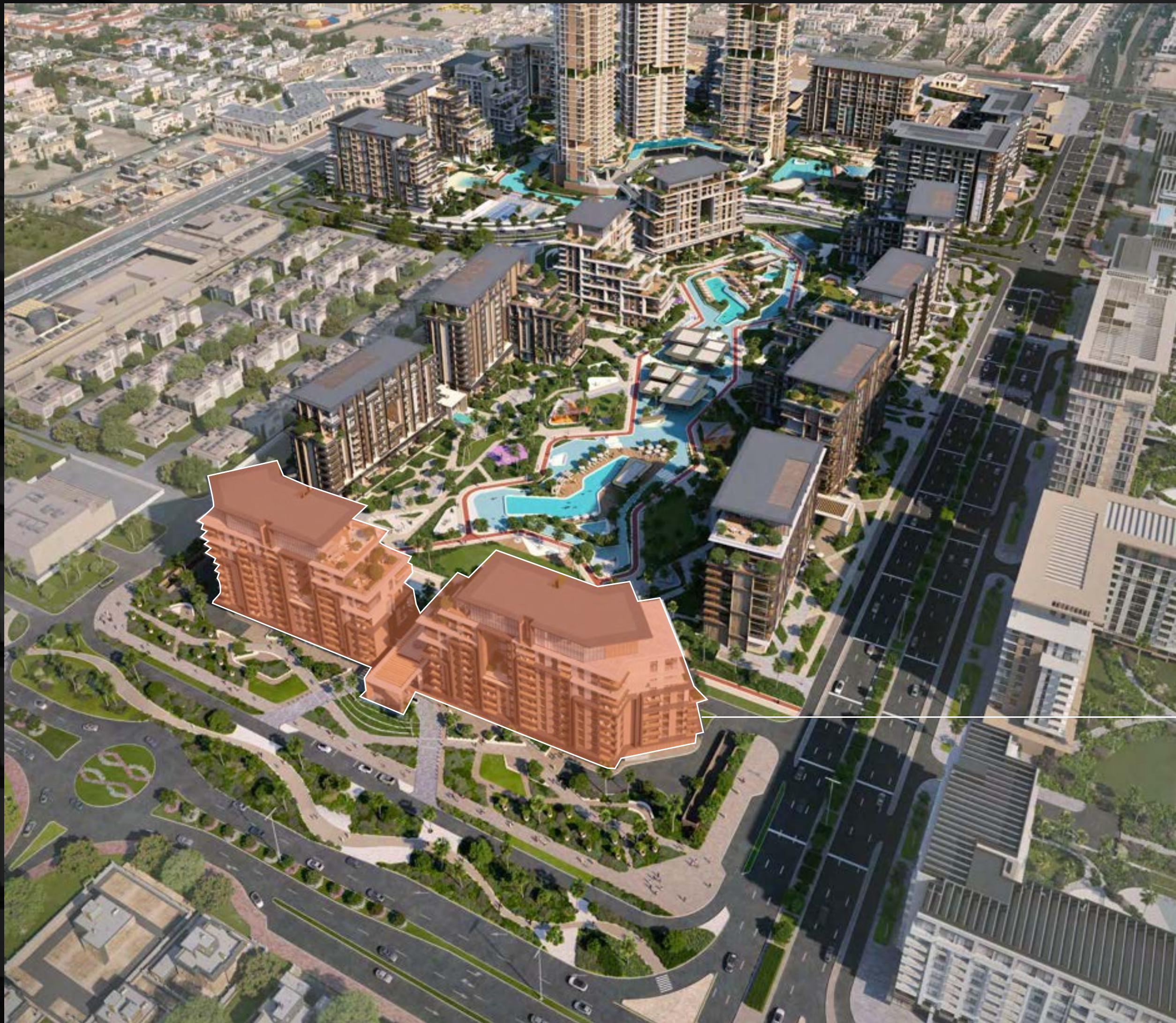

CITY WALK  
CRESTLANE I







# NEW LAUNCH NEW VIBE

Introducing City Walk Crestlane 1, perfectly located in the dynamic centre of the city. This exceptional residence captures the essence of exclusivity, urban convenience, and vibrant community living, adding rhythm to your life. It offers two mid-rise towers with direct access to water features and the park, offering an escape right in the city's core.









# STEP IN

Marking your arrival is a sleek, elevated drop-off that redefines first impressions. Designed to evoke a hotel-style welcome, it appears to float above water—merging warmth with sophistication and setting the tone for a refined living experience from the very first step.

# STAND OUT





Step into a breathtaking double-height lobby, where natural light fills the space and expansive views of lush greenery set the tone. This is more than an entrance—it's a harmonious blend of openness and elegance that defines the dynamic living experience that awaits.

# REFINED BY LIGHT



# CINEMA ROOM

Relax in the exclusive Cinema Room, an elegant lounge setting designed for film viewings or enjoying your favourite live sports in absolute comfort.



# WHERE FUN NEVER ENDS



Discover a themed indoor kids' play area designed to spark creativity and joy. This playful space provides children with a safe and exciting environment to explore.



# URBAN RESIDENCES



THAT FIT  
YOUR FLOW







A photograph of a modern, multi-story apartment building. The building features a mix of light-colored concrete or stone panels and large glass windows. Several balconies are visible, some with glass railings and others with potted plants. The building is set against a clear blue sky. The text is overlaid on the left side of the image.

# 1 TO 3-BEDROOM APARTMENTS

Discover a refined collection of 1- to 3-bedroom apartments that blend contemporary living with panoramic park views, water features, and vibrant city views. Thoughtfully designed interiors showcase high-quality finishes, spacious layouts, and kitchens crafted from premium materials—maximising both comfort and elegance.

For those seeking elevated space and luxury, the signature 3-bedroom residences take it a step further. These exclusive homes feature double-height living areas that open onto expansive private terraces, creating the perfect setting for seamless indoor-outdoor living.

































# 4-BEDROOM DUPLICES

Elevate your living experience with the 4-bedroom duplex units, where every detail defines luxury. Double-height living areas flow effortlessly onto private terraces with direct park access and serene water views, blurring the lines between indoors and outdoors to create a perfect blend of style, functionality, and modern living. Exclusive private lift access from designated parking ensures privacy, while bright, expansive interiors amplify the sense of boundless space.

























# 5-BEDROOM PENTHOUSES

Crafted for those who seek privacy, these 5-bedroom penthouses include double-height living spaces that open onto an exclusive deck with a private pool, overlooking the park, flowing water features, and the city skyline. The master suite features panoramic vistas and a master bathroom with elevated finishes, rich stone detailing, and a freestanding bathtub. Accessed via a private, dedicated lift, every detail is framed by exceptional design and refined finishes.











CRESTLANE I  
5-BEDROOM PENTHOUSES



LIVING ROOM



















