

SIGNATURE

L I V I N G S



NEW ERA OF DUBAI

RETHINK GREEN LIVING IN JUMEIRAH VILLAGE, DUBAI

First solar-powered residential building in heart of Dubai as a step towards converging luxury living with sustainability. Creating sustainable and aesthetically pleasing residential environment in eco-friendly building is an important goal for the future.

Project shape is meticulously designed and crafted from envelope architecture through to your interior designed living space. An astute balance of space, light, materiality and detailing achieves a refined and fundamental visual coherence.

DESIGNED TO MAINTAIN
PHYSICAL, EMOTIONAL, SPIRITUAL
AND MENTAL BALANCE.





THE LOCATION

Circle Mall, Jumeriah Village
5 MINUTES

Al Khail Avenue Mall
10 MINUTES

Mall of the Emirates
12 MINUTES

Palm Jumeirah
18 MINUTES

City Center Me'aisem, IMPZ
10 MINUTES

Downtown
15 MINUTES

Eye Dubai
12 MINUTES

Al Maktoum International
 Airport
20 MINUTES

Expo 2020
20 MINUTES

Expo 2020
20 MINUTES

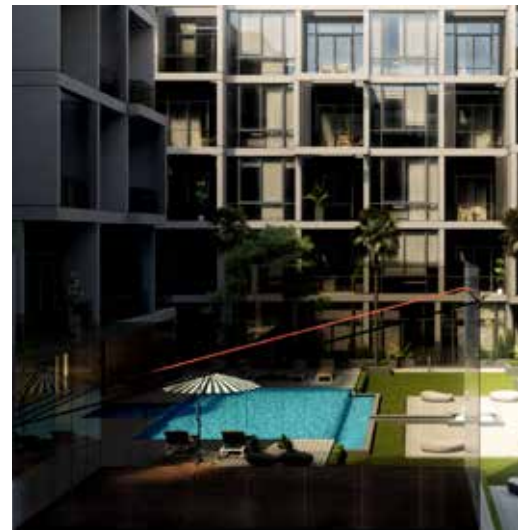



PAYMENT PLAN



ONLY APPLICABLE ON 1 & 2 BEDROOM APARTMENTS

ESCROW ACCOUNT	
Escrow Account Title:	Green Properties Development Co - Signature Livings Trust
Account Number:	019500000166
IBAN:	AE380330000019500000166
Swift Code:	BOMLAEAD
Branch:	Internet City, Dubai
Bank:	Mashreq Bank

Construction linked payment plans

4% Dubai Land Department Registration charges + Admin charges, to be paid with downpayment.

BOOKING PROCESS

RESERVATION

AED 25000/- (nonrefundable) for booking a unit.

DOCUMENTATION

NATIONAL / UAE RESIDENT

- Client information form
- Passport copy, passport copy signature page, visa page and emirates id
- Contact and address undertaking form

NON UAE RESIDENT

- Client information form
- Passport copy, passport copy signature page
- National ID card (where applicable)
- Contact and address undertaking form



THE DEVELOPER

Green Group brings their expertise to some of the finest addresses in the world. Each project is completed with an effortless marriage of design and functionality ensuring signature Precision.

FOR GREEN GROUP

SUSTAINABILITY IS THE WAY TO BE

At Green Group we are the pioneers of bespoke design, from designed sustainable residences to all characterized by an unrivalled combination of detailing, diverse design, cutting edge technology and the exclusivity synonymous with individually tailored projects.

LOCATION: District 10, JVC
MASTER DEVELOPER: NAKHEEL
OWNERSHIP TYPE: Freehold
BUILDING TYPE: 2 Basement + Ground + 4 Floors
HIGH CEILING: 3.6 m
FLOOR TO CEILING WINDOWS: YES
LANDSCAPING: YES
WARRANTY: YES
BUILDING INSURANCE: YES
STORAGE ROOM ON LEASE: YES
INTEGRATED KITCHEN APPLIANCES: YES
SMART HVAC: App enabled

AMENITIES

- Temperature controlled infinity swimming pool
- Jacuzzi
- Landscaping
- 24/7 Concierge
- Gym
- Separate changing rooms and showers
- Glass squash court
- Roof top - bbq area
- Kids play area
- Sun deck

PARKING:

- Covered parking
- Bicycle rack

COMPLETION:

2019 December / Q4



UNIT DETAILS

UNIT TYPES	MINIMUM AREA (SQFT)	MAXIMUM AREA (SQFT)
Studio	400	430
Executive Studio	460	580
Executive 1 Bedroom	700	850
Penthouse 1 Bedroom	875	1000
Penthouse 2 Bedroom	1550	2250



SIGNATURE VILLAS XIV COMPLETED	SIGNATURE VILLAS COMPLETED	THE SIGNATURE JUMEIRAH GOLF ESTATES COMPLETED	SIGNATURE LIVINGS DECEMBER - 2019
---	---	--	--

Office 25 | Oasis Center | Sheikh Zayed Road
Dubai | UAE | P.O.Box 34542

Call/Whatsapp : 056 818 8610
Email : marketing@homes4life.ae
www.homes4life.ae